

PLAN SHOWING PROPOSED CHANGES TO PARKING RESTRICTION

PORTLAND ROAD AND WESTBOURNE GARDENS, HOVE

KEY:- XXX==XXX PROPOSED NO WAITING AND NO LOADING/UNLOADING BAN

REASON:- TO PREVENT OBSTRUCTION AND IMPROVE SAFETY TO ALL VEHICLES

SCALE : NOT TO SCALE REFER ONLY TO MEASUREMENTS

Please see formal notice, to see what other roads have restrictions proposed, where to view the plans and traffic order and how to object or support this proposal



Reproduction from the Ordnance Survey mapping with the Permission of the Controller of H.M. Stationery Office. © Crown Copyright . Unauthorised reproduction infringes Crown copyright and may lead to prosecution or Civil Proceedings. Brighton & Hove Council. Licence : LA09068L, 2003.

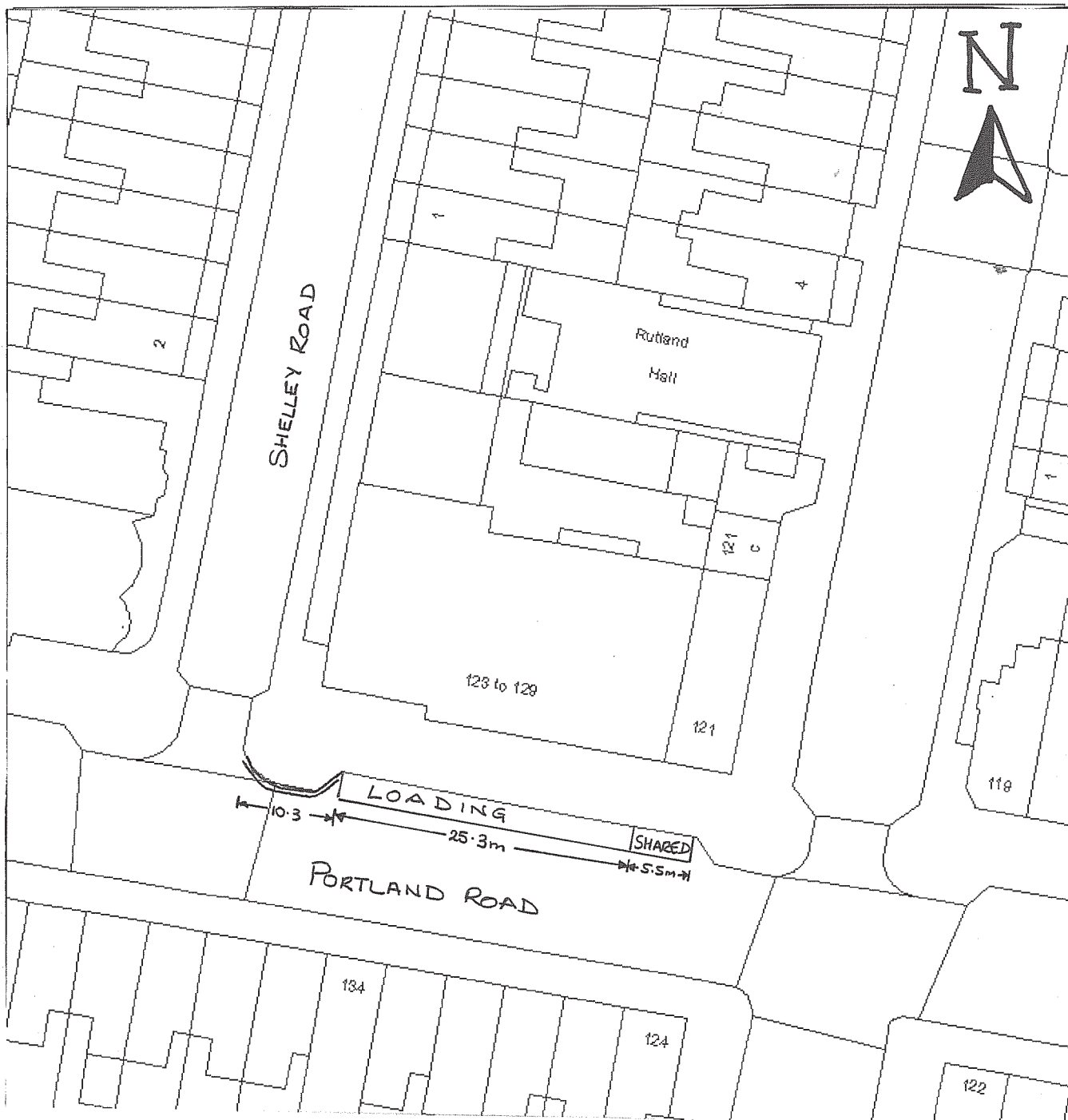

PLAN SHOWING PROPOSED CHANGES TO PARKING RESTRICTION

PORTLAND ROAD, HOVE

KEY:- LOADING PROPOSED LOADING BAY MONDAY TO SUNDAY 8AM TO 6PM

SHARED EXISTING SHARED PARKING

REASON:- TO PROVIDE LOADING BAY FOR BUSINESSES IN THE VICINITY

SCALE : NOT TO SCALE REFER ONLY TO MEASUREMENTS

Reproduction from the Ordnance Survey mapping with the Permission of the Controller of H.M. Stationery Office. © Crown Copyright . Unauthorised reproduction infringes Crown copyright and may lead to prosecution or Civil Proceedings. Brighton & Hove Council. Licence : LA09068L, 2003.





PLAN SHOWING PROPOSED CHANGES TO PARKING RESTRICTION

ST LUKE'S TERRACE, BRIGHTON

KEY:- M/C PROPOSED MOTORCYCLE BAY

REASON:- TO PROVIDE MOTORCYCLE PARKING FACILITIES FOR RESIDENTS AND VISITORS

SCALE : NOT TO SCALE REFER TO MEASUREMENTS

Reproduction from the Ordnance Survey mapping with the Permission of the Controller of H.M. Stationery Office. © Crown Copyright . Unauthorised reproduction infringes Crown copyright and may lead to prosecution or Civil Proceedings. Brighton & Hove Council. Licence : LA09068L, 2003.



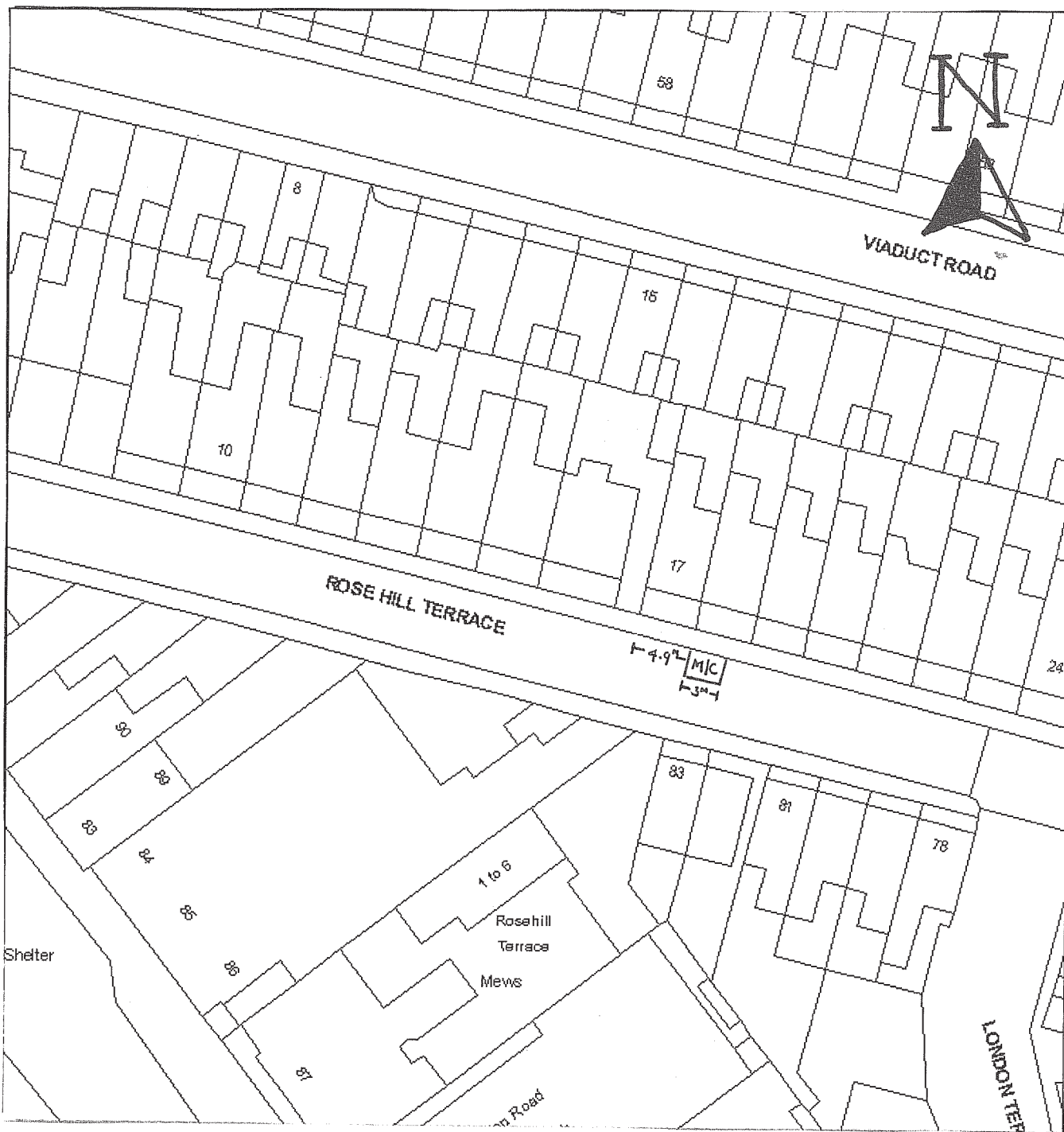

PLAN SHOWING PROPOSED CHANGES TO PARKING RESTRICTION

ROSE HILL TERRACE, BRIGHTON

KEY:- M/C PROPOSED MOTORCYCLE PARKING BAY

REASON:- TO PROVIDE MOTORCYCLE PARKING FOR RESIDENTS AND VISITORS IN THE VICINITY

SCALE : NOT TO SCALE REFER ONLY TO MEASUREMENTS

Reproduction from the Ordnance Survey mapping with the Permission of the Controller of H.M. Stationery Office. © Crown Copyright . Unauthorised reproduction infringes Crown copyright and may lead to prosecution or Civil Proceedings. Brighton & Hove Council. Licence : LA09068L, 2003.



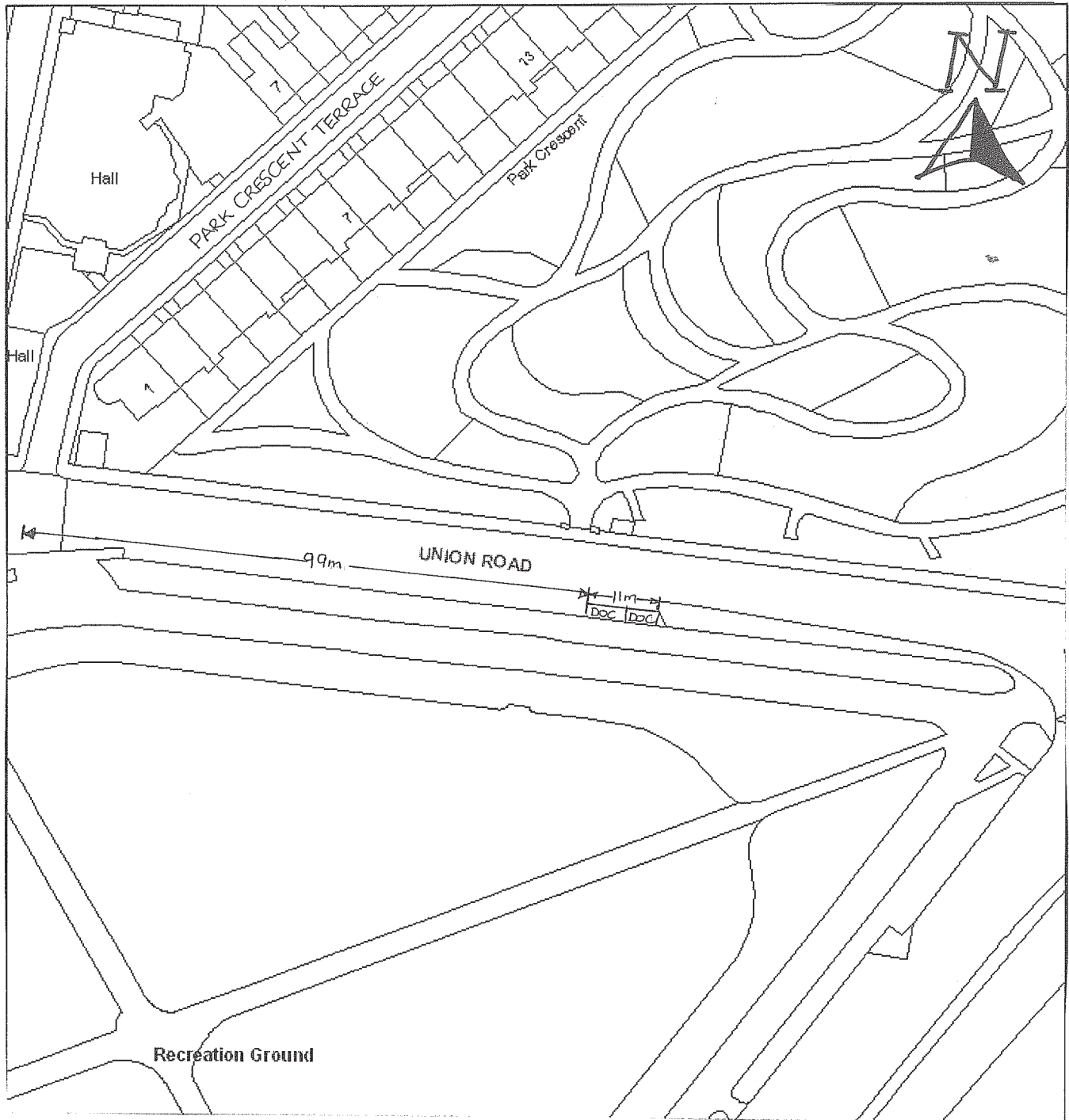

PLAN SHOWING PROPOSED CHANGES TO PARKING RESTRICTION

UNION ROAD, BRIGHTON

KEY:- DOC PROPOSED DOCTOR'S PARKING BAY

REASON:- TO PROVIDE PARKING FOR DOCTOR'S IN THE VICINITY

SCALE : NOT TO SCALE REFER ONLY TO MEASUREMENTS

Reproduction from the Ordnance Survey mapping with the Permission of the Controller of H.M. Stationery Office. © Crown Copyright . Unauthorised reproduction infringes Crown copyright and may lead to prosecution or Civil Proceedings. Brighton & Hove Council. Licence : LA09068L, 2003.





PLAN SHOWING PROPOSED CHANGES TO PARKING RESTRICTION

LABURNUM AVENUE, HOVE

KEY:- PROPOSED DOUBLE YELLOW LINES

REASON:- TO IMPROVE SAFETY FOR BOTH PEDESTRAINS AND VEHICLES IT HELPS TO PREVENT OBSTRUCTION TO ALL VEHICLES

SCALE : NOT TO SCALE REFER ONLY TO MEASUREMENTS

Please see formal notice, to see what other roads have restrictions proposed, where to view the plans and traffic order and how to object or support this proposal



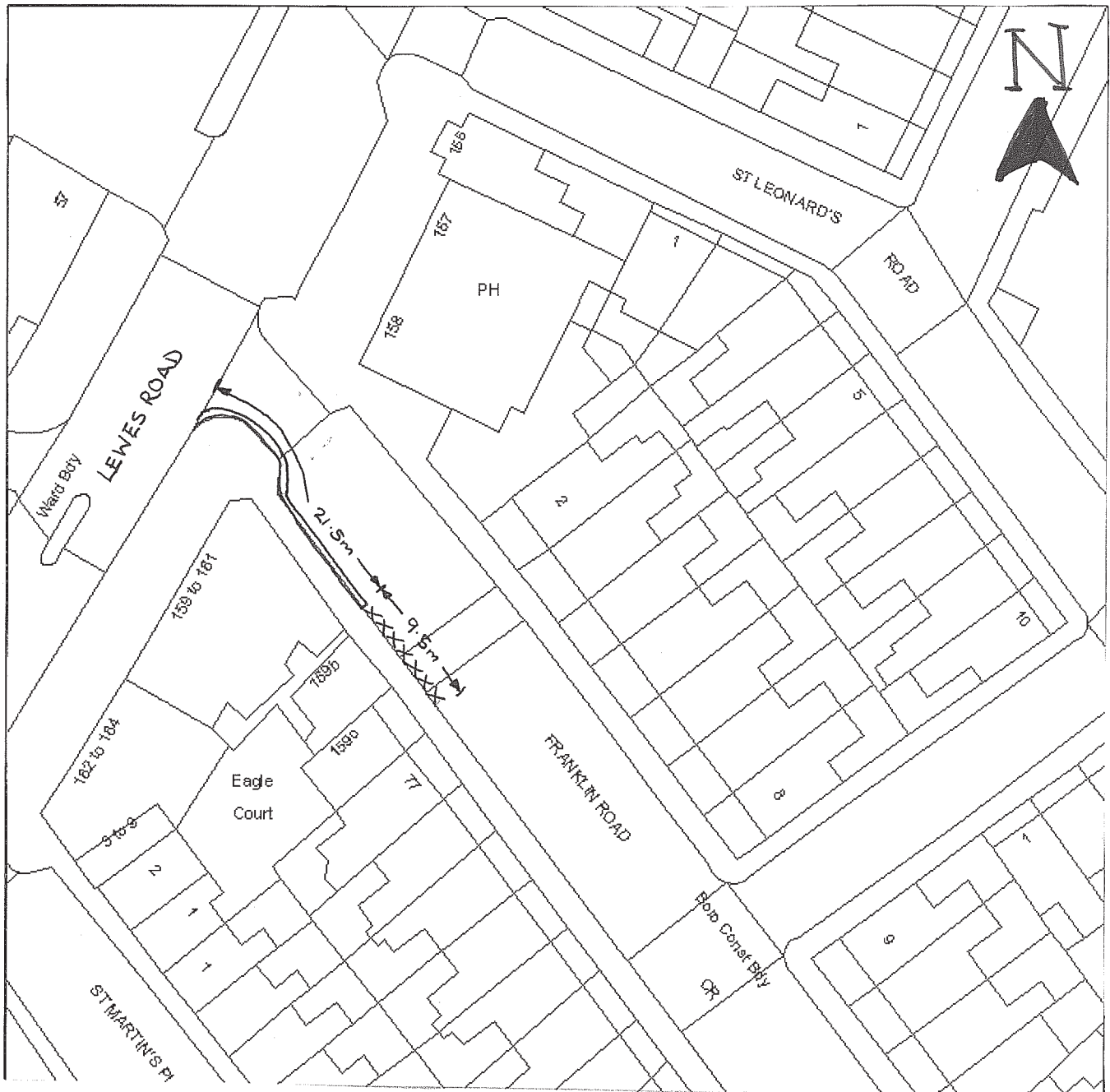

PLAN SHOWING PROPOSED CHANGES TO PARKING RESTRICTION

FRANKLIN ROAD, BRIGHTON

KEY:- X X X X PROPOSED REMOVAL OF DOUBLE YELLOW LINES

REASON:- REDUCING DOUBLE YELLOW LINES TO ALLOW FOR EXTRA PARKING PROVISION

SCALE : NOT TO SCALE REFER ONLY TO MEASUREMENTS

Please see formal notice, to see what other roads have restrictions proposed, where to view the plans and traffic order and how to object or support this proposal



Brighton & Hove

Reproduction from the Ordnance Survey mapping with the Permission of the Controller of H.M. Stationery Office. © Crown Copyright . Unauthorised reproduction infringes Crown copyright and may lead to prosecution or Civil Proceedings. Brighton & Hove Council. Licence : LA09068L, 2003.

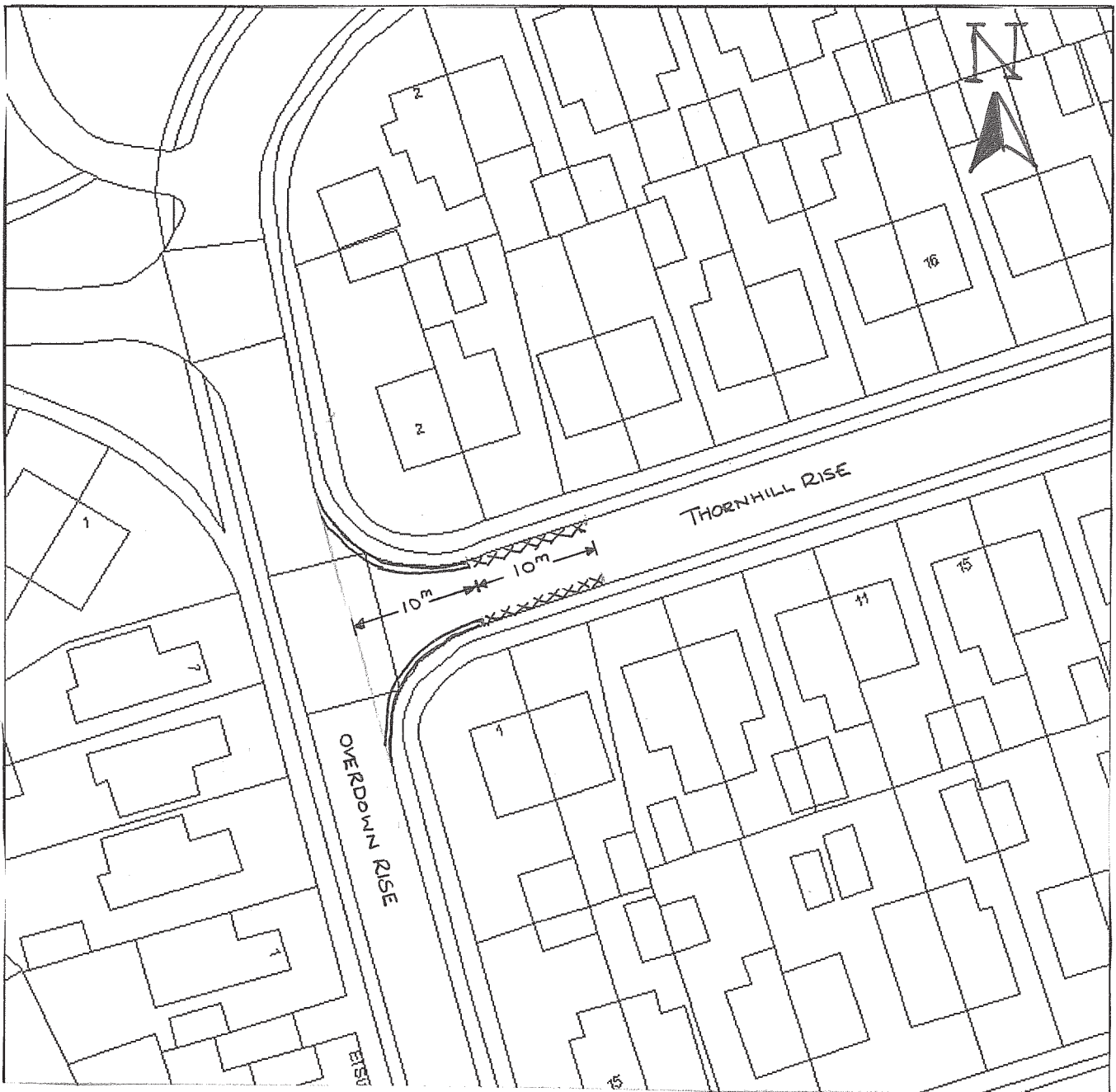

PLAN SHOWING PROPOSED CHANGES TO PARKING RESTRICTION

THORNHILL RISE, PORTSLADE

KEY:- x x x x PROPOSED REDUCTION OF DOUBLE YELLOW LINES
 = = = = EXISTING DOUBLE YELLOW LINES

REASON:- REDUCING DOUBLE YELLOW LINES TO ALLOW FOR EXTRA PARKING PROVISION

SCALE : NOT TO SCALE REFER ONLY TO MEASUREMENTS

Please see formal notice, to see what other roads have restrictions proposed, where to view the plans and traffic order and how to object or support this proposal

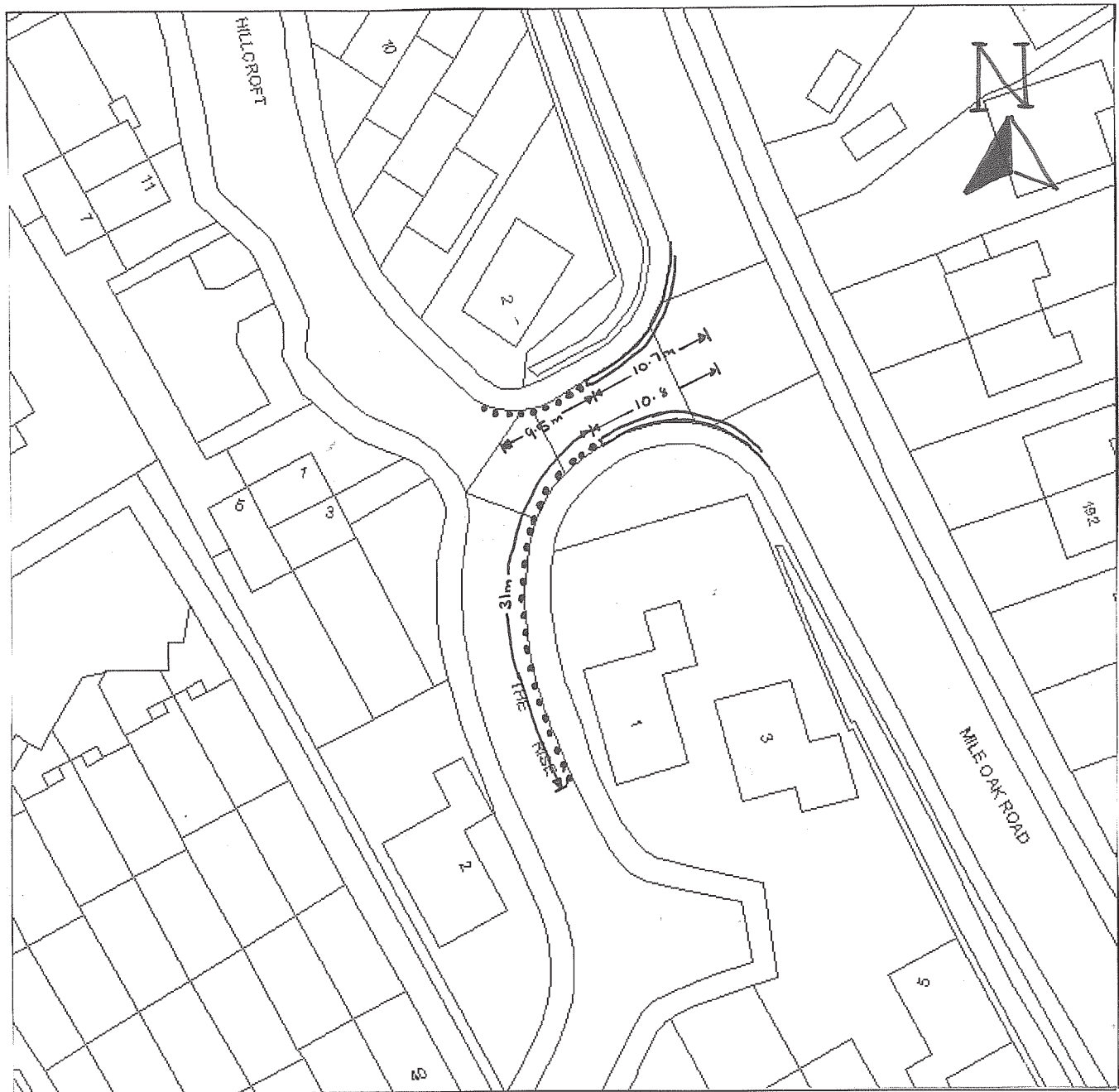

PLAN SHOWING PROPOSED CHANGES TO PARKING RESTRICTION

THE RISE, PORTSLADE

KEY:- PROPOSED DOUBLE YELLOW LINES
 = = = = = EXISTING DOUBLE YELLOW LINES

REASON:- TO IMPROVE SAFETY FOR BOTH PEDESTRAINS AND VEHICLES IT HELPS TO PREVENT OBSTRUCTION TO ALL VEHICLES

SCALE : NOT TO SCALE REFER ONLY TO MEASUREMENTS

Please see formal notice, to see what other roads have restrictions proposed, where to view the plans and traffic order and how to object or support this proposal

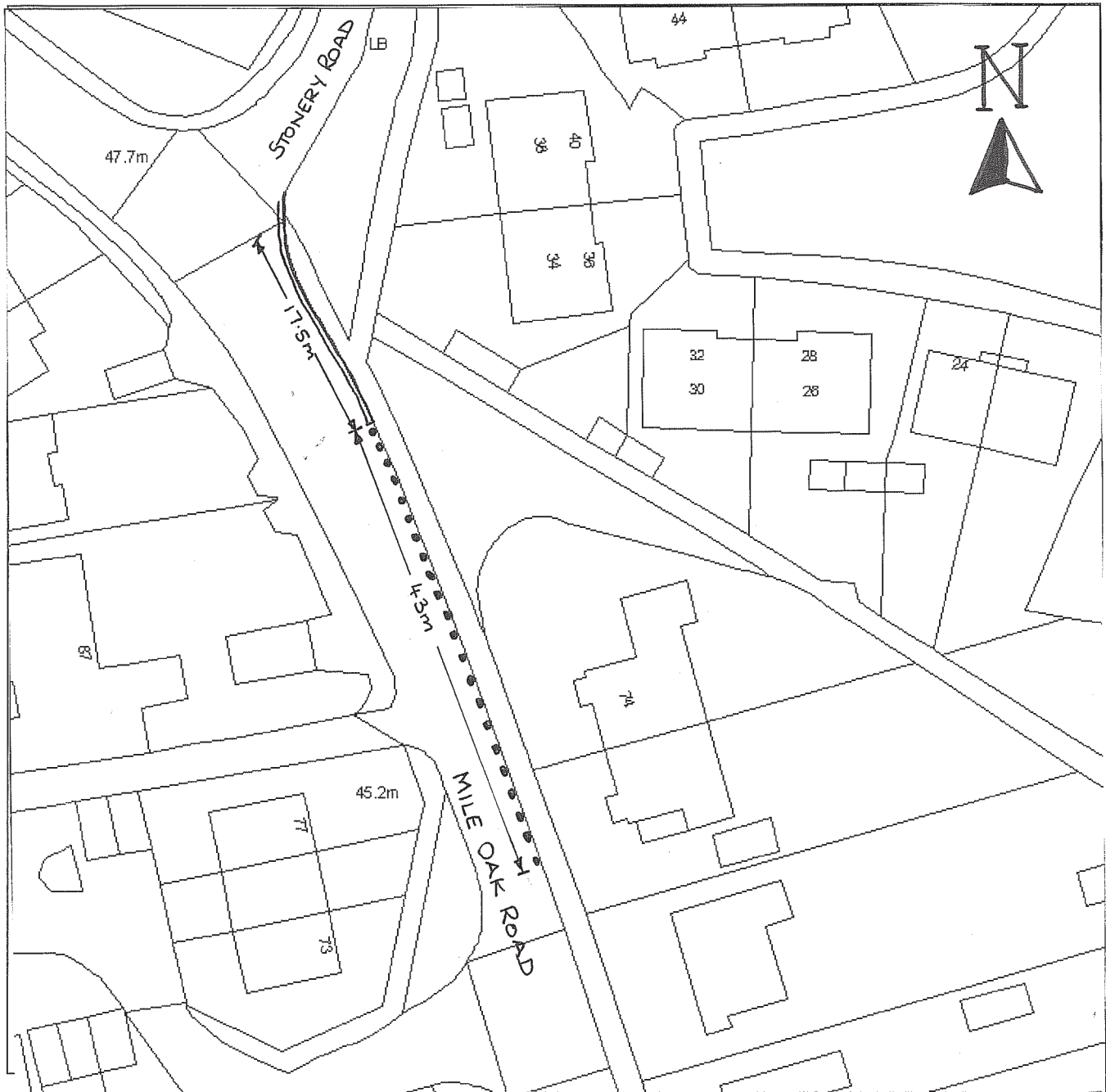

PLAN SHOWING PROPOSED CHANGES TO PARKING RESTRICTION

MILE OAK ROAD, PORTSLADE

KEY:- PROPOSED DOUBLE YELLOW LINES
 === EXISTING DOUBLE YELLOW LINES

REASON:- TO IMPROVE SAFETY FOR BOTH PEDESTRAINS AND VEHICLES IT HELPS TO PREVENT OBSTRUCTION TO ALL VEHICLES

SCALE : NOT TO SCALE REFER ONLY TO MEASUREMENTS

Please see formal notice, to see what other roads have restrictions proposed, where to view the plans and traffic order and how to object or support this proposal

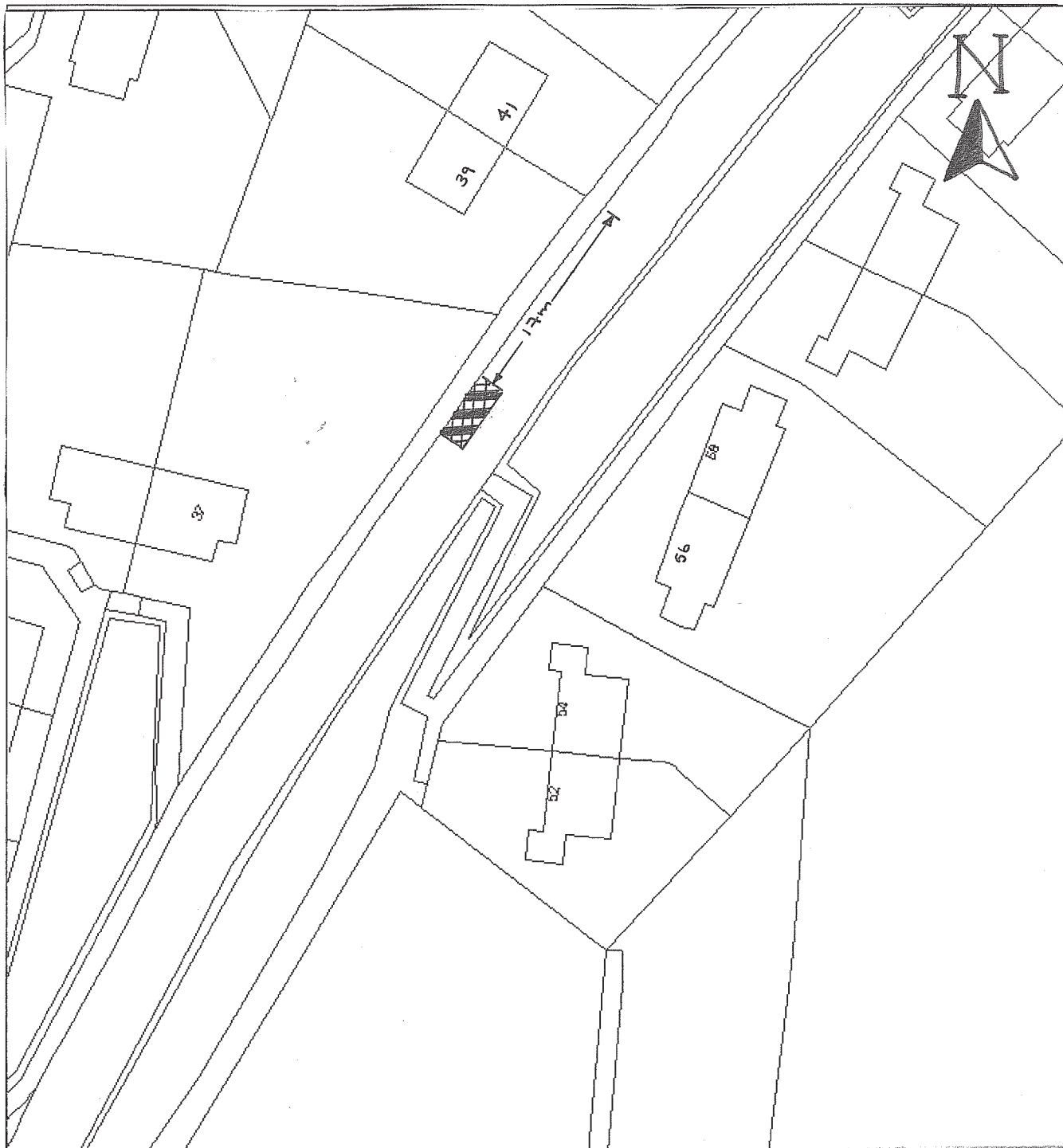

PLAN SHOWING PROPOSED CHANGES TO PARKING RESTRICTION

56 AUCKLAND DRIVE, BRIGHTON

KEY:-  PROPOSED RELOCATION OF DISABLED PARKING BAY

REASON:- TO RELOCATE DISABLED PARKING BAY AS REQUESTED BY A RESIDENT IN THE VICINITY

SCALE : NOT TO SCALE REFER TO MEASUREMENTS

Reproduction from the Ordnance Survey mapping with the Permission of the Controller of H.M. Stationery Office. © Crown Copyright . Unauthorised reproduction infringes Crown copyright and may lead to prosecution or Civil Proceedings. Brighton & Hove Council. Licence : LA09068L, 2003.



PLAN SHOWING PROPOSED CHANGES TO PARKING RESTRICTION

OLD LONDON ROAD, BRIGHTON

KEY:- LTD PROPOSED REMOVAL OF LIMITED WAITING

REASON:- REMOVING LIMITED WAITING AS PART OF THEM ARE OVER A CROSS OVER

SCALE : NOT TO SCALE REFER ONLY TO MEASUREMENTS

Reproduction from the Ordnance Survey mapping with the Permission of the Controller of H.M. Stationery Office. © Crown Copyright . Unauthorised reproduction infringes Crown copyright and may lead to prosecution or Civil Proceedings. Brighton & Hove Council. Licence : LA09068L, 2003.





PLAN SHOWING PROPOSED CHANGES TO PARKING RESTRICTION

OSBORNE ROAD, BRIGHTON

KEY:- MIC PROPOSED MOTORCYCLE BAY

REASON:- TO PROVIDE MOTORCYCLE PARKING FOR RESIDENTS & VISITORS IN THE VICINITY

SCALE : **NOT TO SCALE REFER ONLY TO MEASUREMENTS**

Reproduction from the Ordnance Survey mapping with the Permission of the Controller of H.M. Stationery Office. © Crown Copyright . Unauthorised reproduction infringes Crown copyright and may lead to prosecution or Civil Proceedings. Brighton & Hove Council. Licence : LA09068L, 2003.



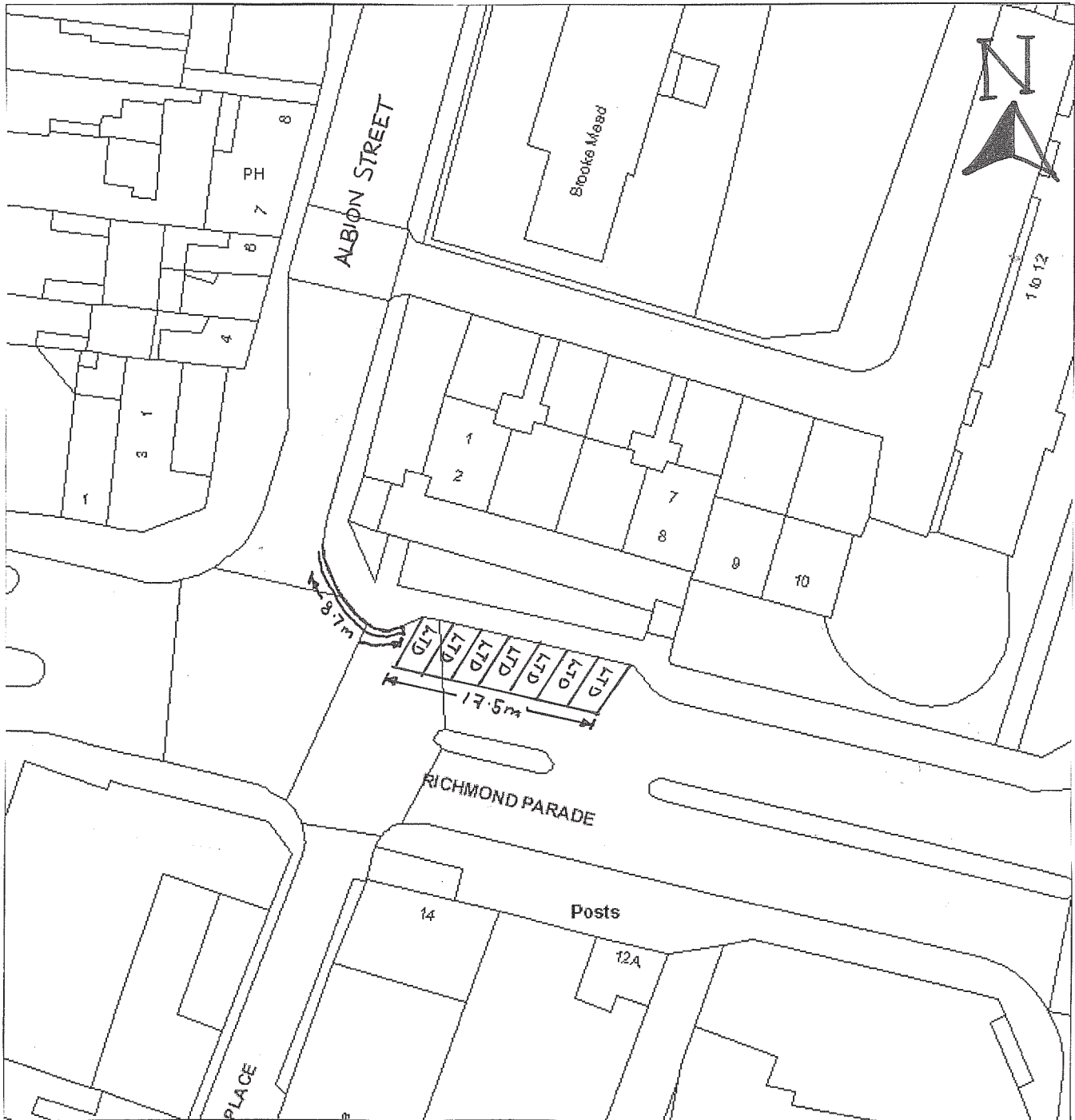

PLAN SHOWING PROPOSED CHANGES TO PARKING RESTRICTION

RICHMOND PARADE, BRIGHTON

- KEY:-** LTD PROPOSED LIMITED WAITING FOR 1 HOUR (NO RETURN WITHIN 1 HOUR MONDAY TO SATURDAY 9AM TO 6PM)
- EXISTING DOUBLE YELLOW LINES

REASON:- TO PROVIDE PARKING FOR NEARBY FACILITIES

SCALE : NOT TO SCALE REFER ONLY TO MEASUREMENTS

Reproduction from the Ordnance Survey mapping with the Permission of the Controller of H.M. Stationery Office. © Crown Copyright . Unauthorised reproduction infringes Crown copyright and may lead to prosecution or Civil Proceedings. Brighton & Hove Council. Licence : LA09068L, 2003.





**PLAN SHOWING PROPOSED CHANGES TO PARKING RESTRICTION
WINDMILL STREET, BRIGHTON**

- KEY:-** M/C PROPOSED MOTORCYCLE BAY
C/C EXISTING CAR CLUB BAY
 EXISTING DOUBLE YELLOW LINES

REASON:- TO PROVIDE MOTORCYCLE PARKING FOR RESIDENTS AND VISITORS IN THE VICINITY

SCALE : NOT TO SCALE REFER ONLY TO MEASUREMENTS

Reproduction from the Ordnance Survey mapping with the Permission of the Controller of H.M. Stationery Office. © Crown Copyright . Unauthorised reproduction infringes Crown copyright and may lead to prosecution or Civil Proceedings. Brighton & Hove Council. Licence : LA09068L, 2003.

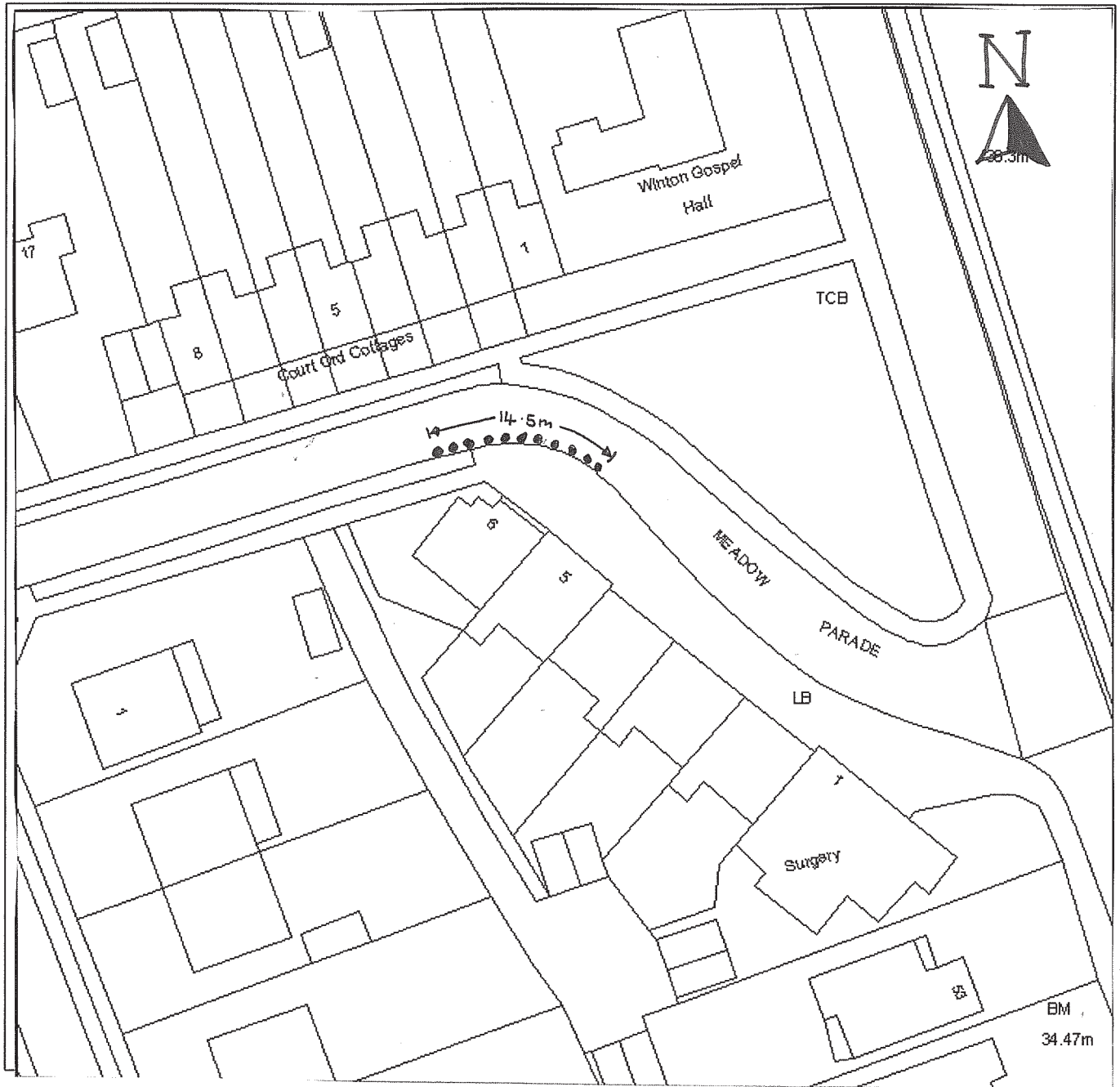

PLAN SHOWING PROPOSED CHANGES TO PARKING RESTRICTION

MEADOW PARADE, BRIGHTON

KEY:- PROPOSED DOUBLE YELLOW LINES

REASON:- TO IMPROVE SAFETY FOR BOTH PEDESTRAINS AND VEHICLES IT HELPS TO PREVENT OBSTRUCTION TO ALL VEHICLES

SCALE : NOT TO SCALE REFER ONLY TO MEASUREMENTS

Please see formal notice, to see what other roads have restrictions proposed, where to view the plans and traffic order and how to object or support this proposal



Reproduction from the Ordnance Survey mapping with the Permission of the Controller of H.M. Stationery Office. © Crown Copyright . Unauthorised reproduction infringes Crown copyright and may lead to prosecution or Civil Proceedings. Brighton & Hove Council. Licence : LA09068L, 2003.

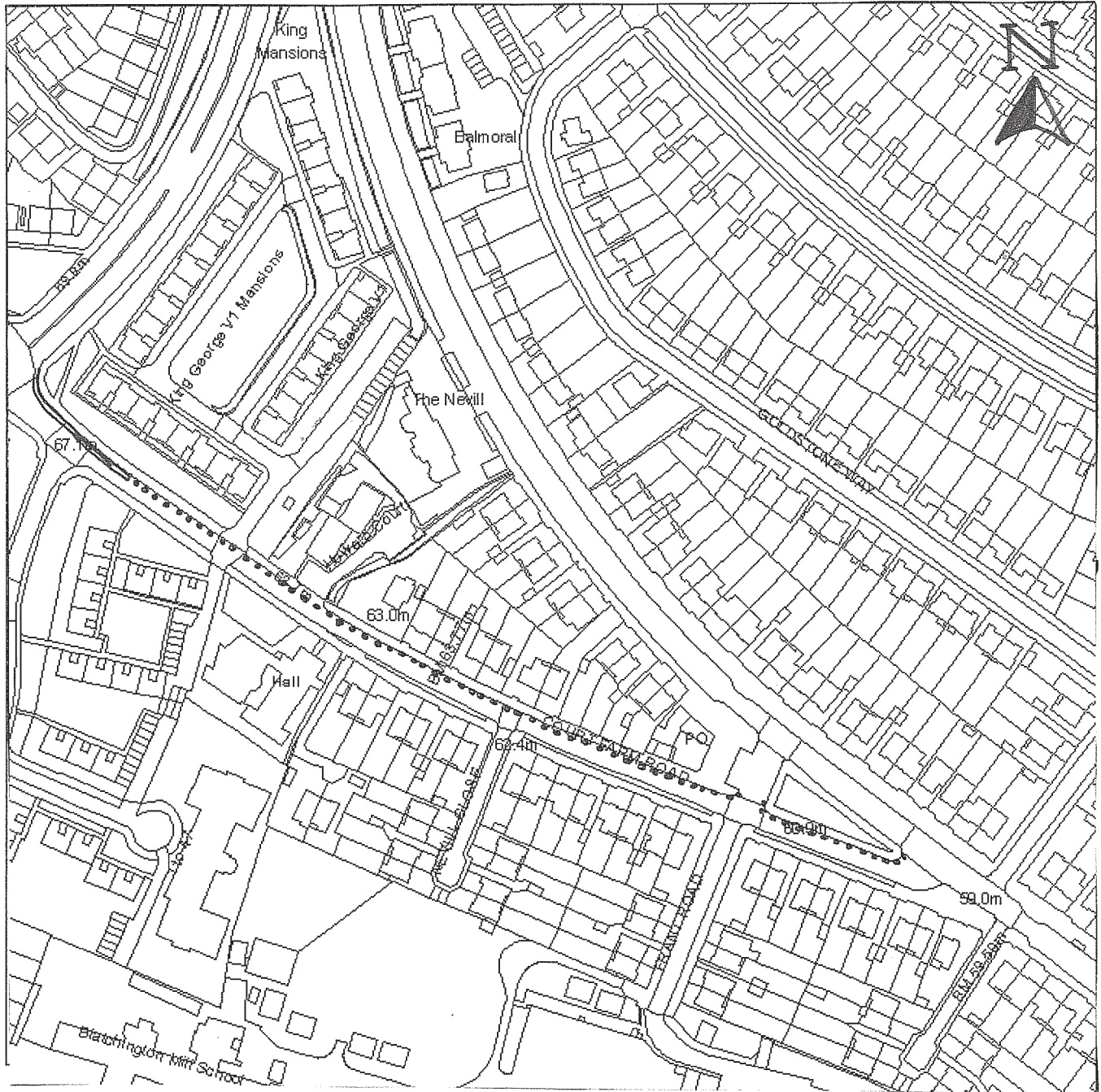

PLAN SHOWING PROPOSED CHANGES TO PARKING RESTRICTION

COURT FARM ROAD, HOVE

KEY:- PROPOSED DOUBLE YELLOW LINES
 ===== EXISTING DOUBLE YELLOW LINES

REASON:- TO IMPROVE SAFETY FOR BOTH PEDESTRAINS AND VEHICLES IT HELPS TO PREVENT OBSTRUCTION TO ALL VEHICLES

SCALE : NOT TO SCALE REFER ONLY TO MEASUREMENTS

Please see formal notice, to see what other roads have restrictions proposed, where to view the plans and traffic order and how to object or support this proposal

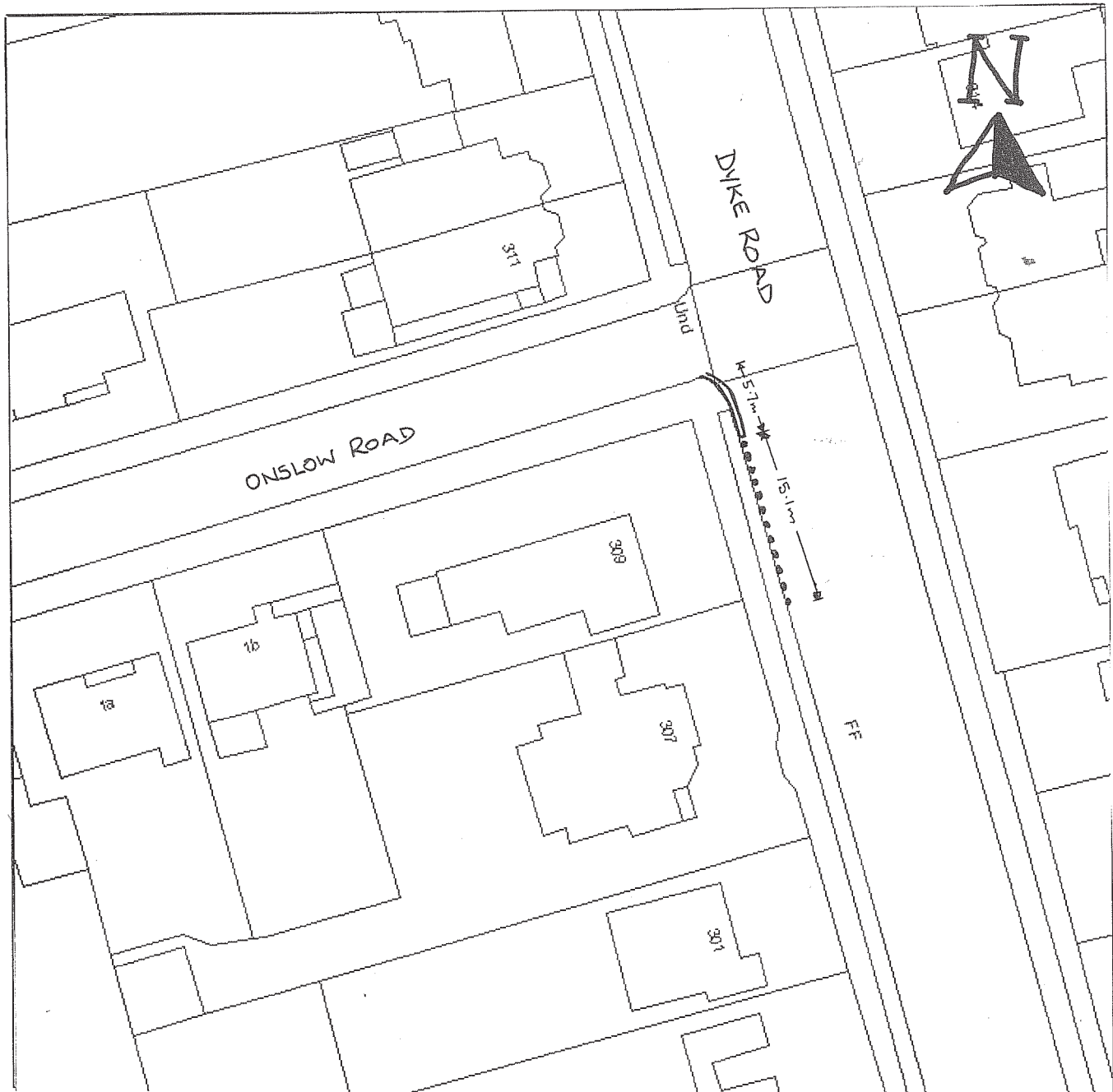

PLAN SHOWING PROPOSED CHANGES TO PARKING RESTRICTION

DYKE ROAD, HOVE

KEY:- PROPOSED DOUBLE YELLOW LINES
 === EXISTING DOUBLE YELLOW LINES

REASON:- TO IMPROVE SAFETY FOR BOTH PEDESTRAINS AND VEHICLES IT HELPS TO PREVENT OBSTRUCTION TO ALL VEHICLES

SCALE : NOT TO SCALE REFER ONLY TO MEASUREMENTS

Please see formal notice, to see what other roads have restrictions proposed, where to view the plans and traffic order and how to object or support this proposal

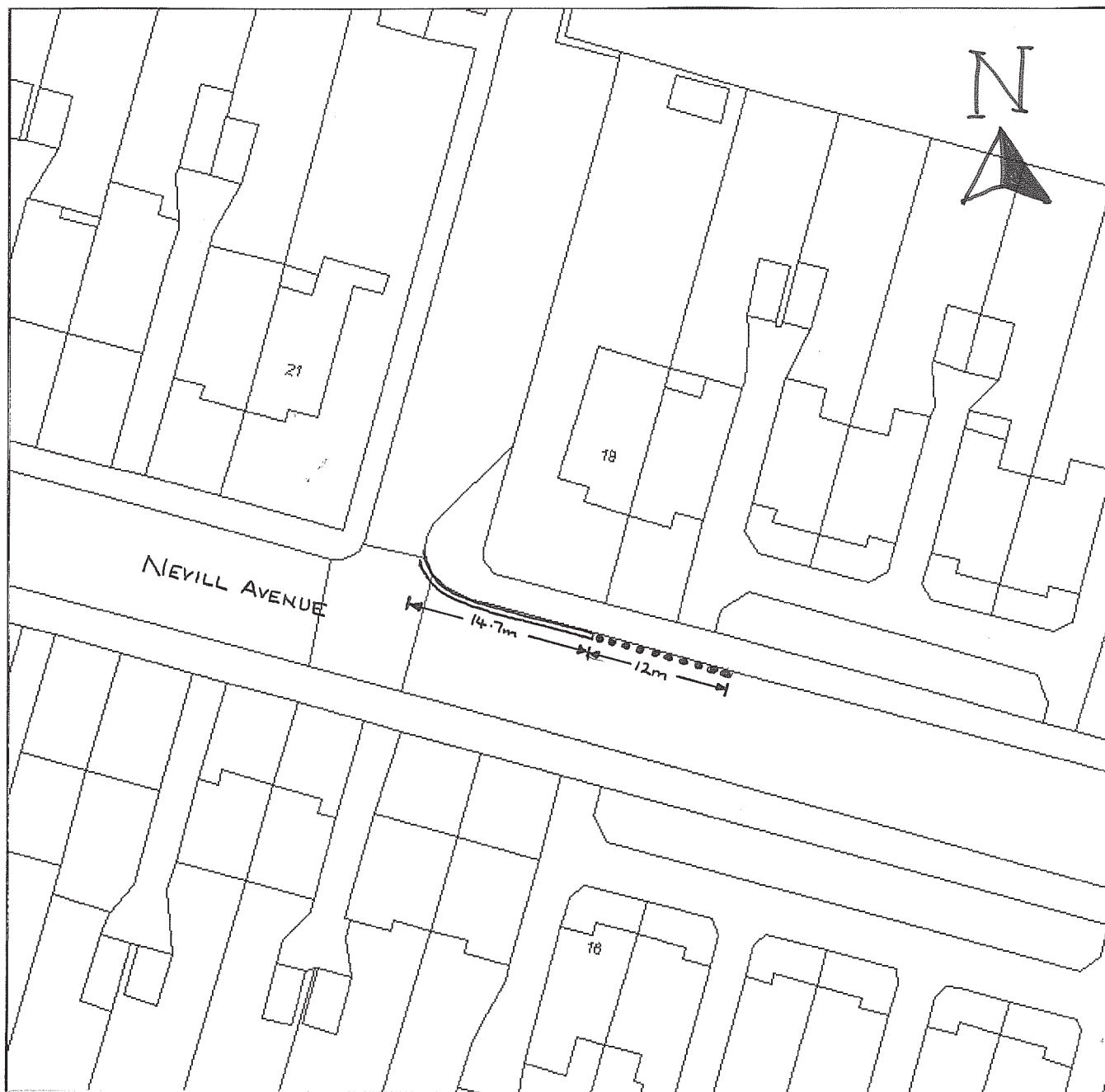

PLAN SHOWING PROPOSED CHANGES TO PARKING RESTRICTION

NEVILL AVENUE, HOVE

KEY:- PROPOSED DOUBLE YELLOW LINES
 === EXISTING DOUBLE YELLOW LINES

REASON:- TO IMPROVE SAFETY FOR BOTH PEDESTRAINS AND VEHICLES IT HELPS TO PREVENT OBSTRUCTION TO ALL VEHICLES

SCALE : NOT TO SCALE REFER ONLY TO MEASUREMENTS

Please see formal notice, to see what other roads have restrictions proposed, where to view the plans and traffic order and how to object or support this proposal

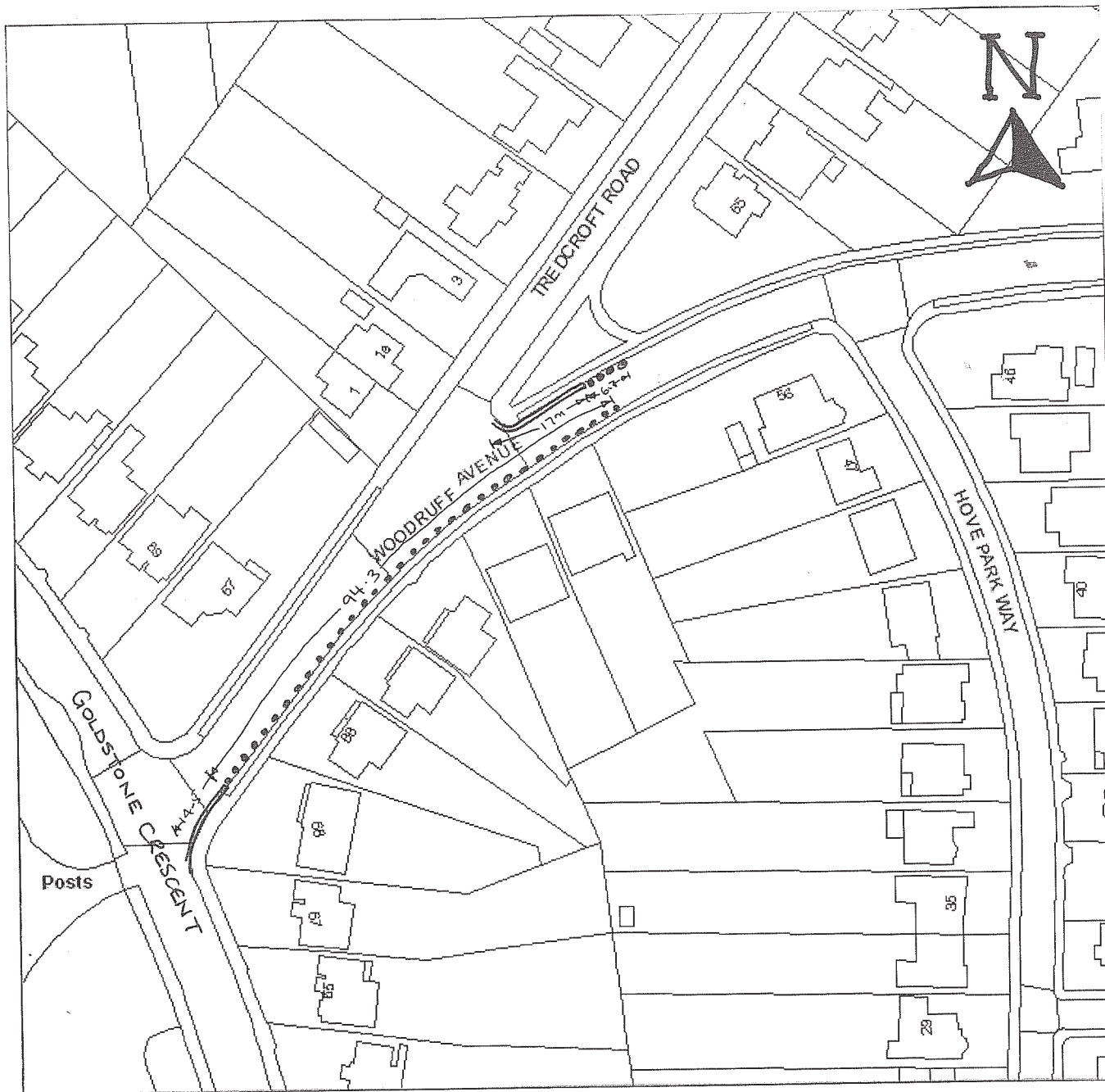

PLAN SHOWING PROPOSED CHANGES TO PARKING RESTRICTION

WOODRUFF AVENUE, HOVE

KEY:- PROPOSED DOUBLE YELLOW LINES
 ===== EXISTING DOUBLE YELLOW LINES

REASON:- TO IMPROVE SAFETY FOR BOTH PEDESTRAINS AND VEHICLES IT HELPS TO PREVENT OBSTRUCTION TO ALL VEHICLES

SCALE : NOT TO SCALE REFER ONLY TO MEASUREMENTS

Please see formal notice, to see what other roads have restrictions proposed, where to view the plans and traffic order and how to object or support this proposal

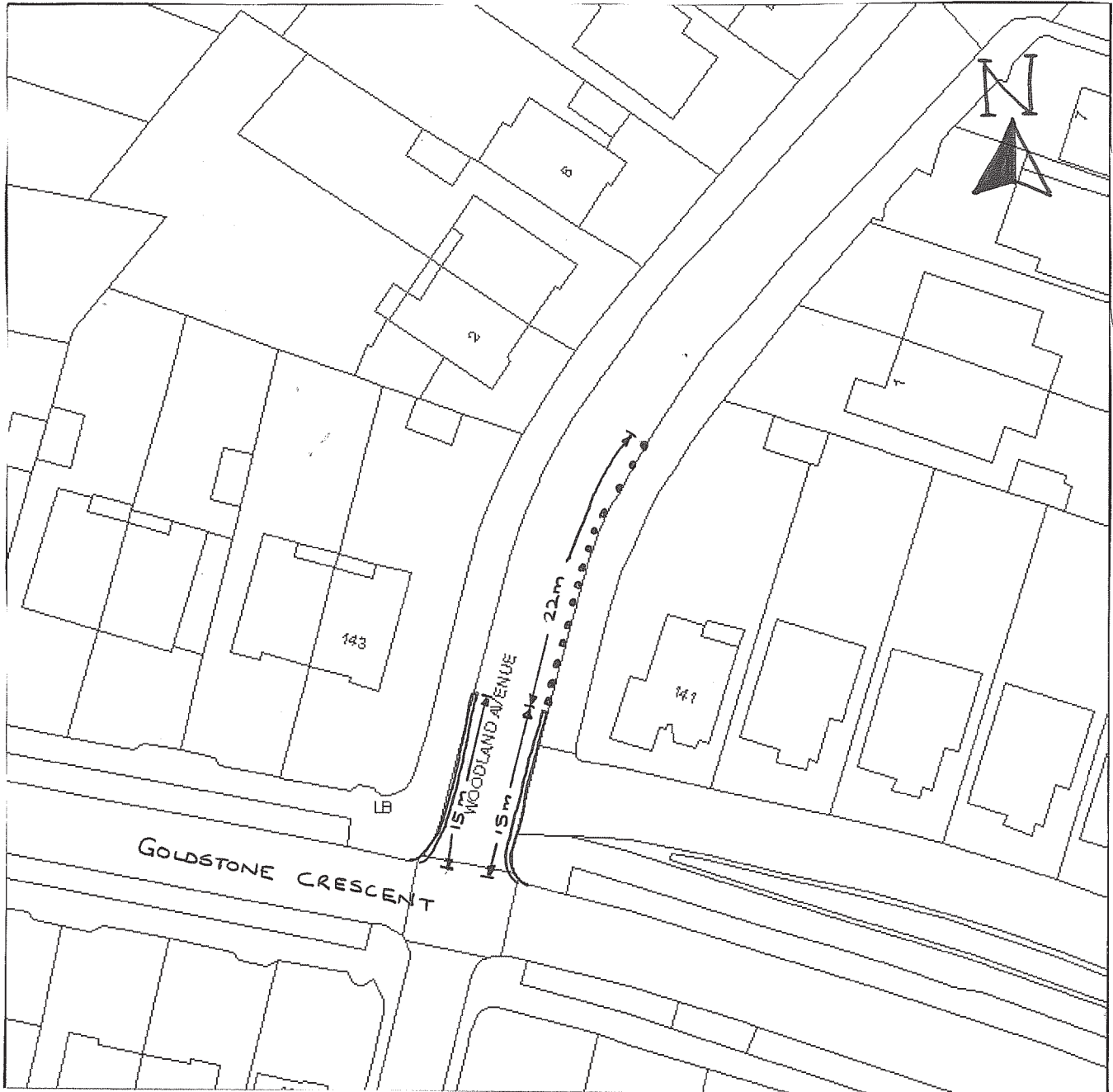

PLAN SHOWING PROPOSED CHANGES TO PARKING RESTRICTION

WOODLAND AVENUE, HOVE

KEY:- PROPOSED DOUBLE YELLOW LINES
 === EXISTING DOUBLE YELLOW LINES

REASON:- TO IMPROVE SAFETY FOR BOTH PEDESTRAINS AND VEHICLES IT HELPS TO PREVENT OBSTRUCTION TO ALL VEHICLES

SCALE : NOT TO SCALE REFER ONLY TO MEASUREMENTS

Please see formal notice, to see what other roads have restrictions proposed, where to view the plans and traffic order and how to object or support this proposal

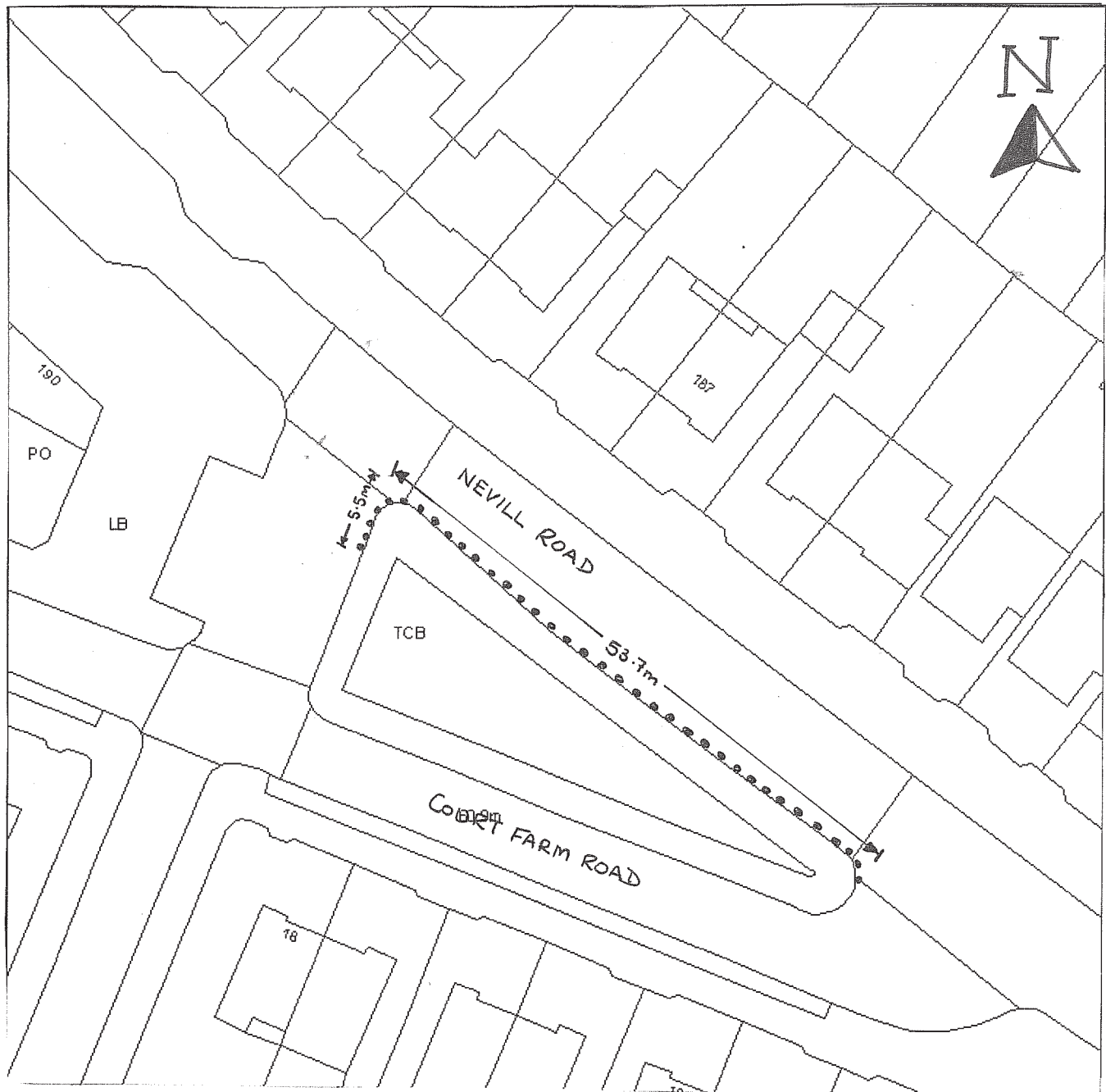

PLAN SHOWING PROPOSED CHANGES TO PARKING RESTRICTION

NEVILL ROAD, HOVE

KEY:- PROPOSED DOUBLE YELLOW LINES

REASON:- TO IMPROVE SAFETY FOR BOTH PEDESTRAINS AND VEHICLES IT HELPS TO PREVENT OBSTRUCTION TO ALL VEHICLES

SCALE : NOT TO SCALE REFER ONLY TO MEASUREMENTS

Please see formal notice, to see what other roads have restrictions proposed, where to view the plans and traffic order and how to object or support this proposal



Reproduction from the Ordnance Survey mapping with the Permission of the Controller of H.M. Stationery Office. © Crown Copyright . Unauthorised reproduction infringes Crown copyright and may lead to prosecution or Civil Proceedings. Brighton & Hove Council. Licence : LA09068L, 2003.

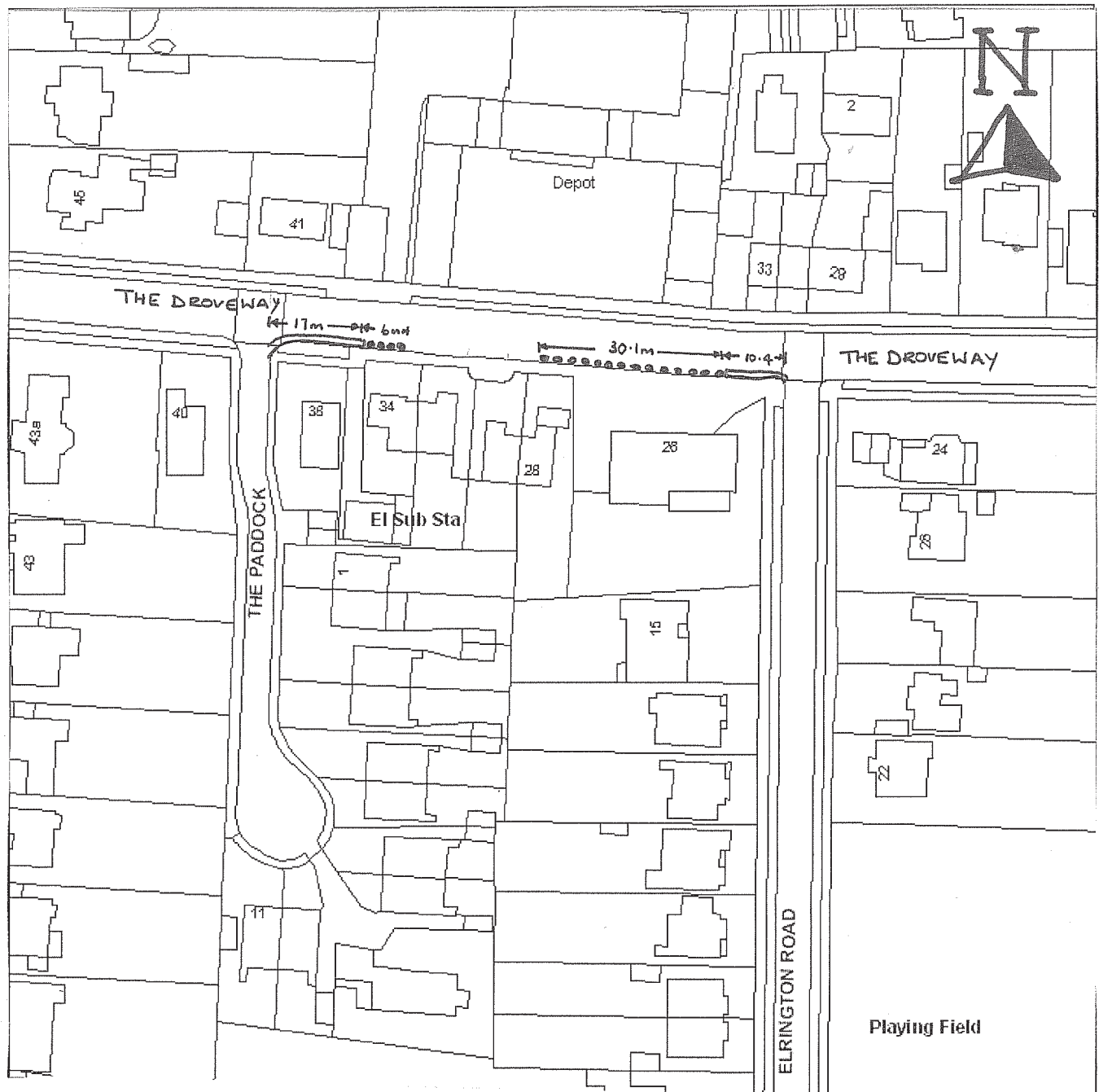

PLAN SHOWING PROPOSED CHANGES TO PARKING RESTRICTION

THE DROVEWAY, HOVE

KEY:- PROPOSED DOUBLE YELLOW LINES
 === EXISTING DOUBLE YELLOW LINES

REASON:- TO IMPROVE SAFETY FOR BOTH PEDESTRAINS AND VEHICLES IT HELPS TO PREVENT OBSTRUCTION TO ALL VEHICLES

SCALE : NOT TO SCALE REFER ONLY TO MEASUREMENTS

Please see formal notice, to see what other roads have restrictions proposed, where to view the plans and traffic order and how to object or support this proposal

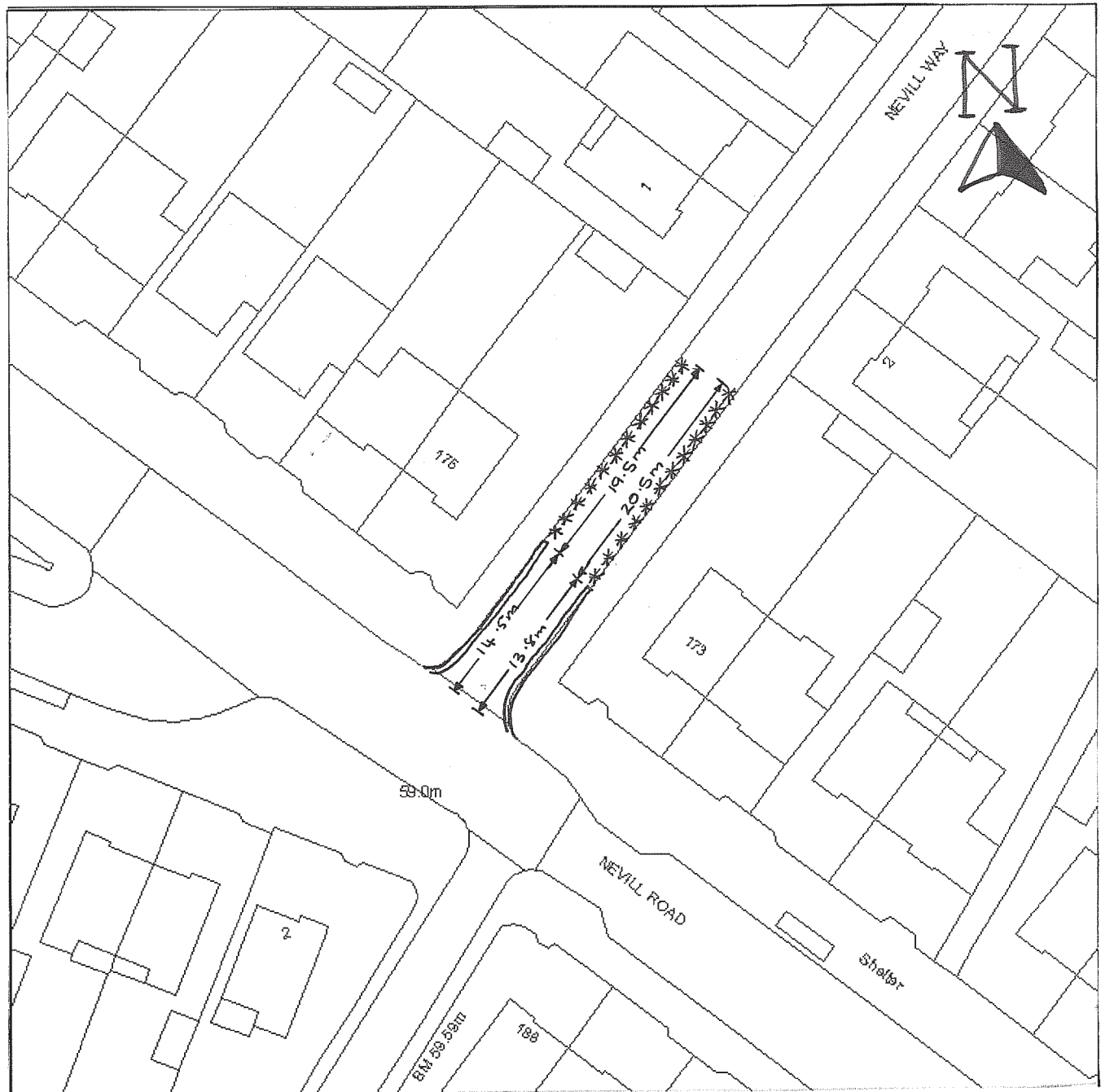

PLAN SHOWING PROPOSED CHANGES TO PARKING RESTRICTION

NEVILL WAY, HOVE

KEY:- **** PROPOSED SINGLE YELLOW LINE - MONDAY TO SATURDAY 8AM TO 6PM
 === EXISTING DOUBLE YELLOW LINES

REASON:- TO PREVENT PARKING THOURGHOUT THE DAY AS THIS CAUSES OBSTRUCTION TO BUS AND OTHER LARGE VEHICLES

SCALE : NOT TO SCALE REFER ONLY TO MEASUREMENTS

Please see formal notice, to see what other roads have restrictions proposed, where to view the plans and traffic order and how to object or support this proposal



Reproduction from the Ordnance Survey mapping with the Permission of the Controller of H.M. Stationery Office. © Crown Copyright . Unauthorised reproduction infringes Crown copyright and may lead to prosecution or Civil Proceedings. Brighton & Hove Council. Licence : LA09068L, 2003.

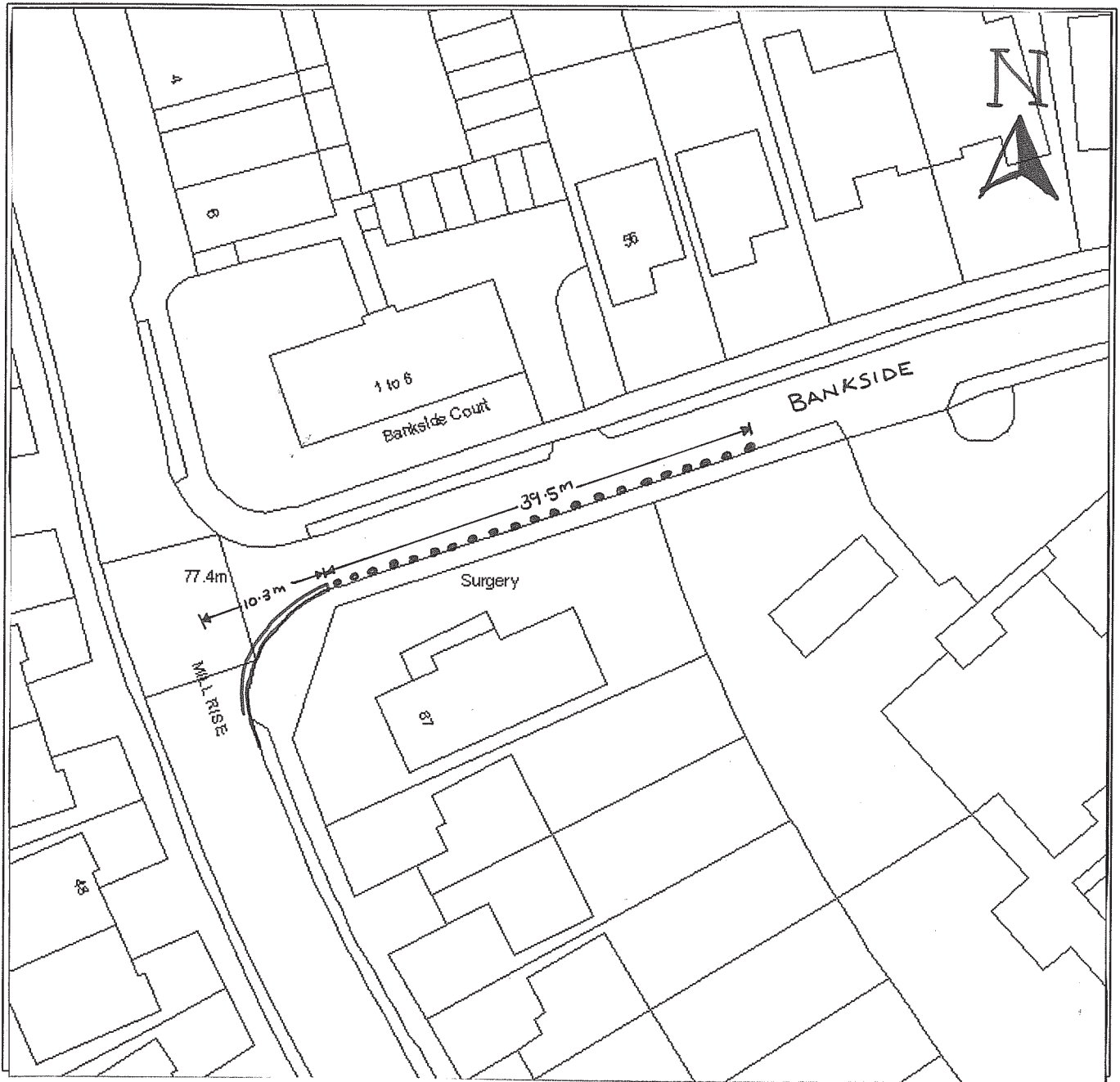

PLAN SHOWING PROPOSED CHANGES TO PARKING RESTRICTION

BANKSIDE, BRIGHTON

KEY:- PROPOSED DOUBLE YELLOW LINES
 === EXISTING DOUBLE YELLOW LINES

REASON:- TO IMPROVE SAFETY FOR BOTH PEDESTRAINS AND VEHICLES IT HELPS TO PREVENT OBSTRUCTION TO ALL VEHICLES

SCALE : NOT TO SCALE REFER ONLY TO MEASUREMENTS

Please see formal notice, to see what other roads have restrictions proposed, where to view the plans and traffic order and how to object or support this proposal

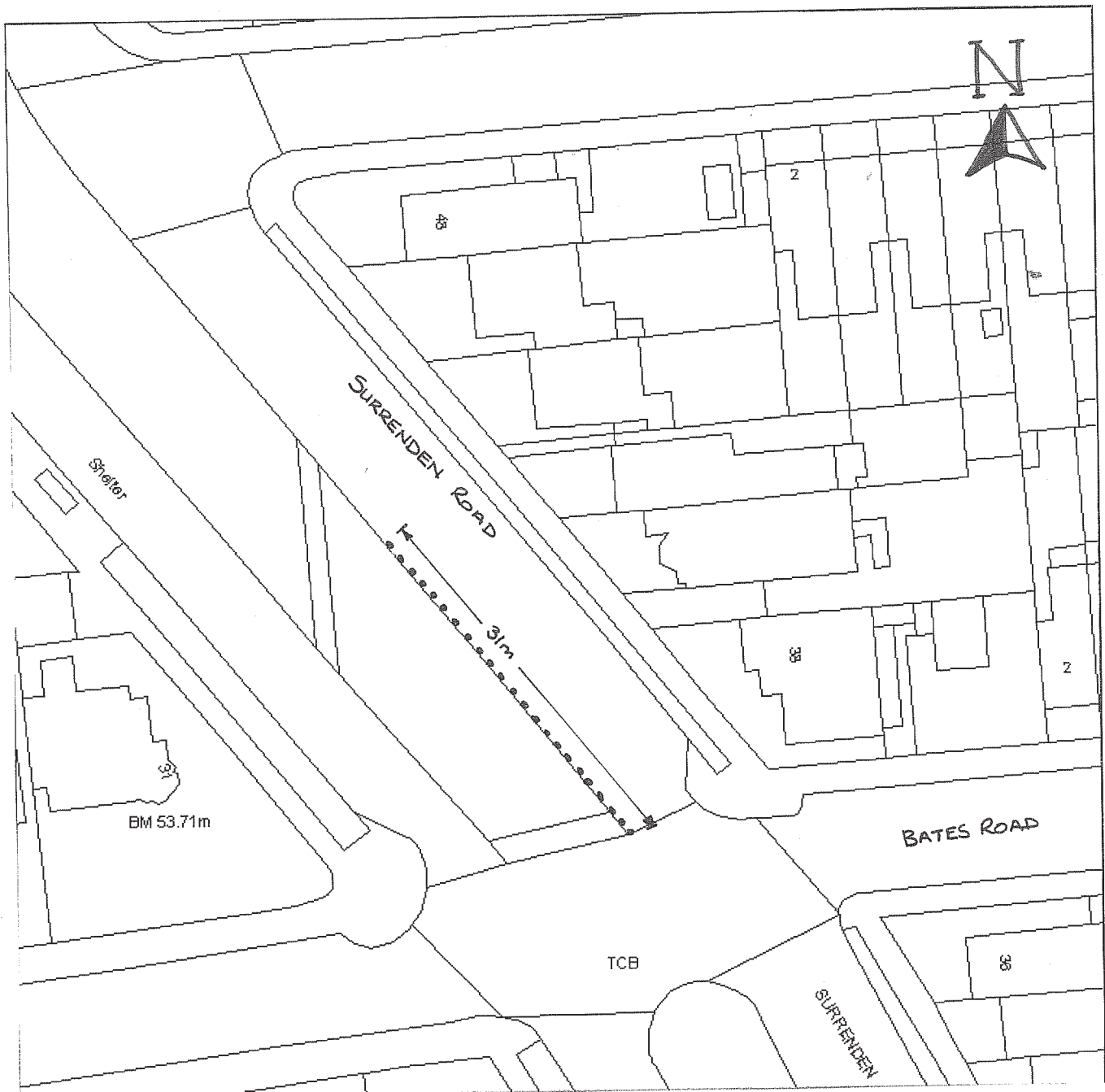

PLAN SHOWING PROPOSED CHANGES TO PARKING RESTRICTION

SURRENDEN ROAD, BRIGHTON

KEY:- PROPOSED DOUBLE YELLOW LINES

REASON:- TO IMPROVE SAFETY AND VISIBILITY FOR ALL ROAD USERS

SCALE : NOT TO SCALE REFER ONLY TO MEASUREMENTS

Please see formal notice, to see what other roads have restrictions proposed, where to view the plans and traffic order and how to object or support this proposal



Reproduction from the Ordnance Survey mapping with the Permission of the Controller of H.M. Stationery Office. © Crown Copyright . Unauthorised reproduction infringes Crown copyright and may lead to prosecution or Civil Proceedings. Brighton & Hove Council. Licence : LA09068L, 2003.

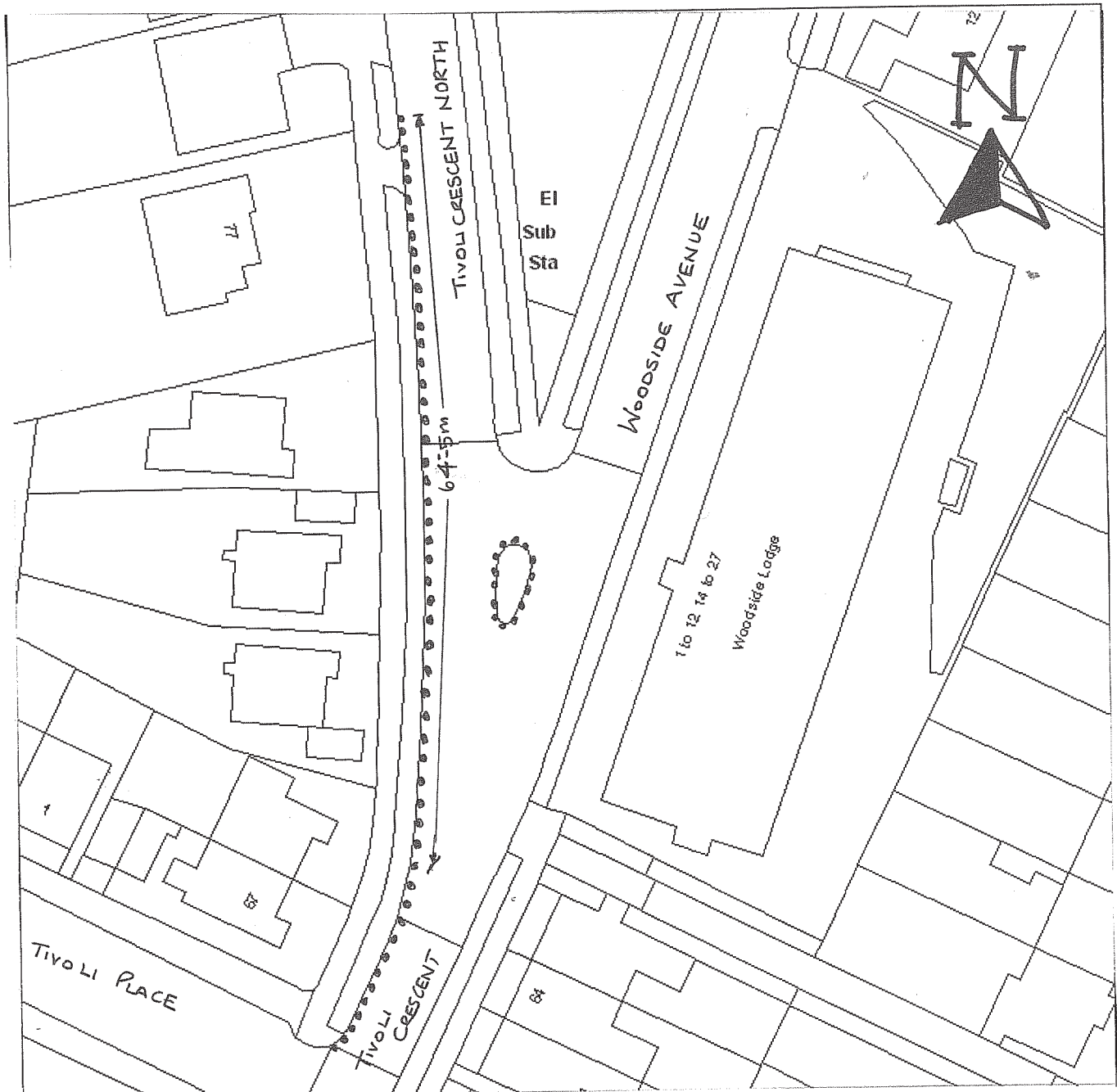

PLAN SHOWING PROPOSED CHANGES TO PARKING RESTRICTION

TIVOLI CRESCENT NORTH, TIVOLI CRESCENT & WOODSIDE AVENUE, BRIGHTON

KEY:- PROPOSED DOUBLE YELLOW LINES

REASON:- TO IMPROVE SAFETY FOR BOTH PEDESTRAINS AND VEHICLES IT HELPS TO PREVENT OBSTRUCTION TO ALL VEHICLES

SCALE : NOT TO SCALE REFER ONLY TO MEASUREMENTS

Please see formal notice, to see what other roads have restrictions proposed, where to view the plans and traffic order and how to object or support this proposal

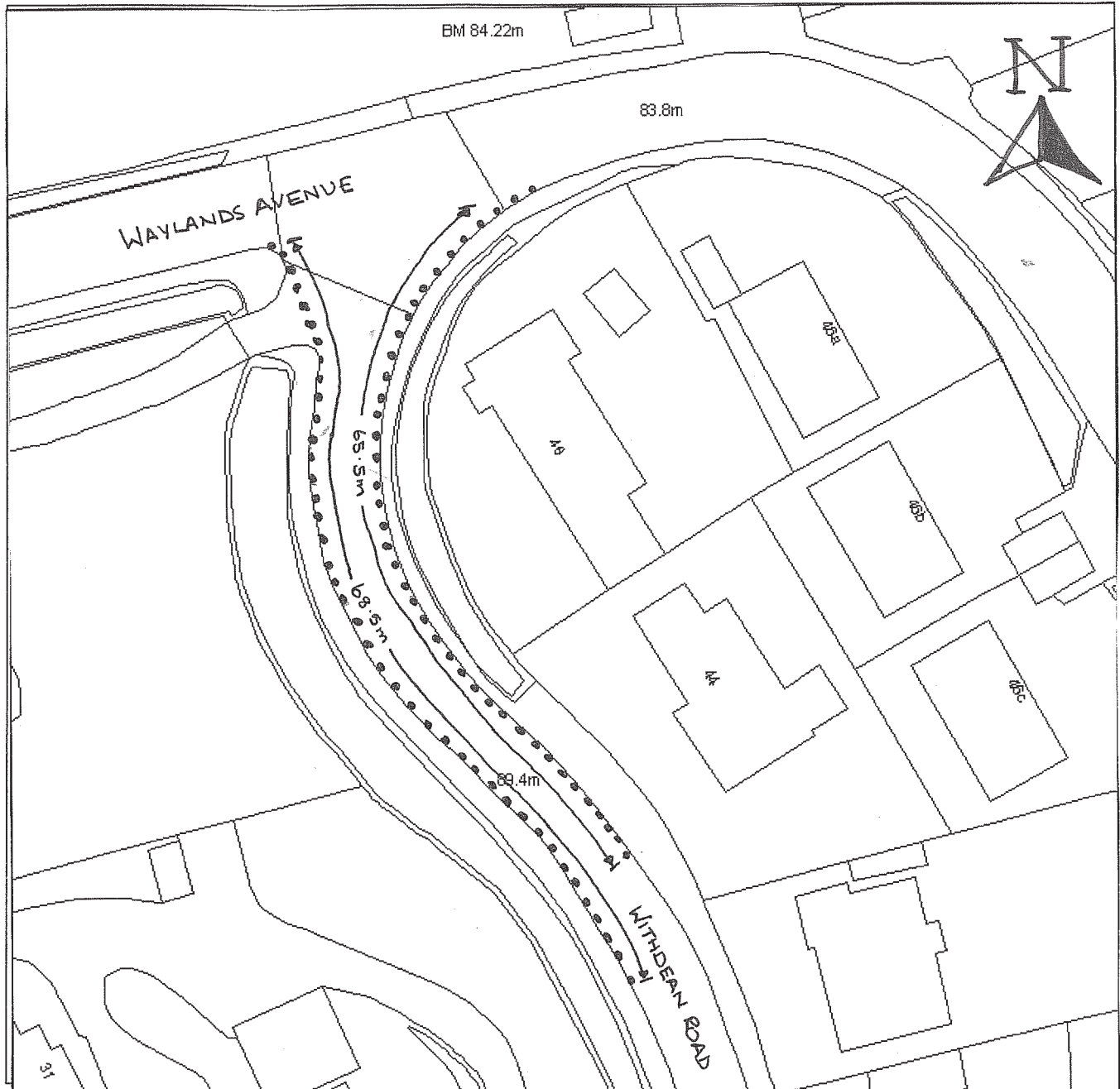

PLAN SHOWING PROPOSED CHANGES TO PARKING RESTRICTION

WITHDEAN ROAD, BRIGHTON

KEY:- PROPOSED DOUBLE YELLOW LINES

REASON:- TO IMPROVE SAFETY FOR BOTH PEDESTRAINS AND VEHICLES IT HELPS TO PREVENT OBSTRUCTION TO ALL VEHICLES

SCALE : NOT TO SCALE REFER ONLY TO MEASUREMENTS

Please see formal notice, to see what other roads have restrictions proposed, where to view the plans and traffic order and how to object or support this proposal

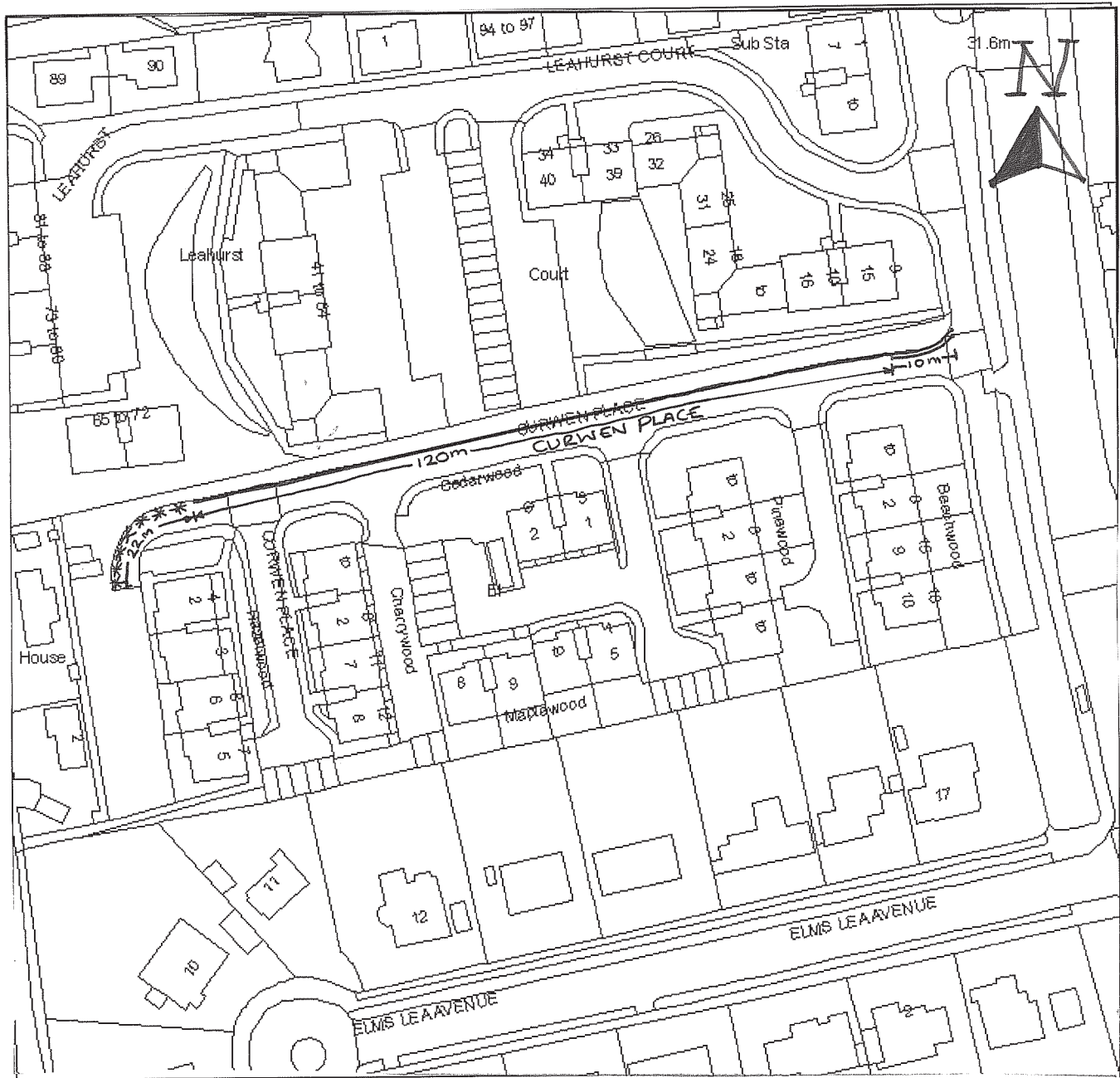

PLAN SHOWING PROPOSED CHANGES TO PARKING RESTRICTION

CURWEN PLACE, BRIGHTON

- KEY:-** **** PROPOSED SINGLE YELLOW LINE MONDAY TO SATURDAY 8AM TO 6PM
 ——— EXISTING SINGLE YELLOW LINE MONDAY TO SATURDAY 8AM TO 6PM
 = = = EXISTING DOUBLE YELLOW LINES

REASON:- TO PREVENT PARKING ON ONE SIDE OF THE ROAD AS THIS CAUSES OBSTRUCTION TO PASSING VEHICLES

SCALE : NOT TO SCALE REFER ONLY TO MEASUREMENTS

Please see formal notice, to see what other roads have restrictions proposed, where to view the plans and traffic order and how to object or support this proposal

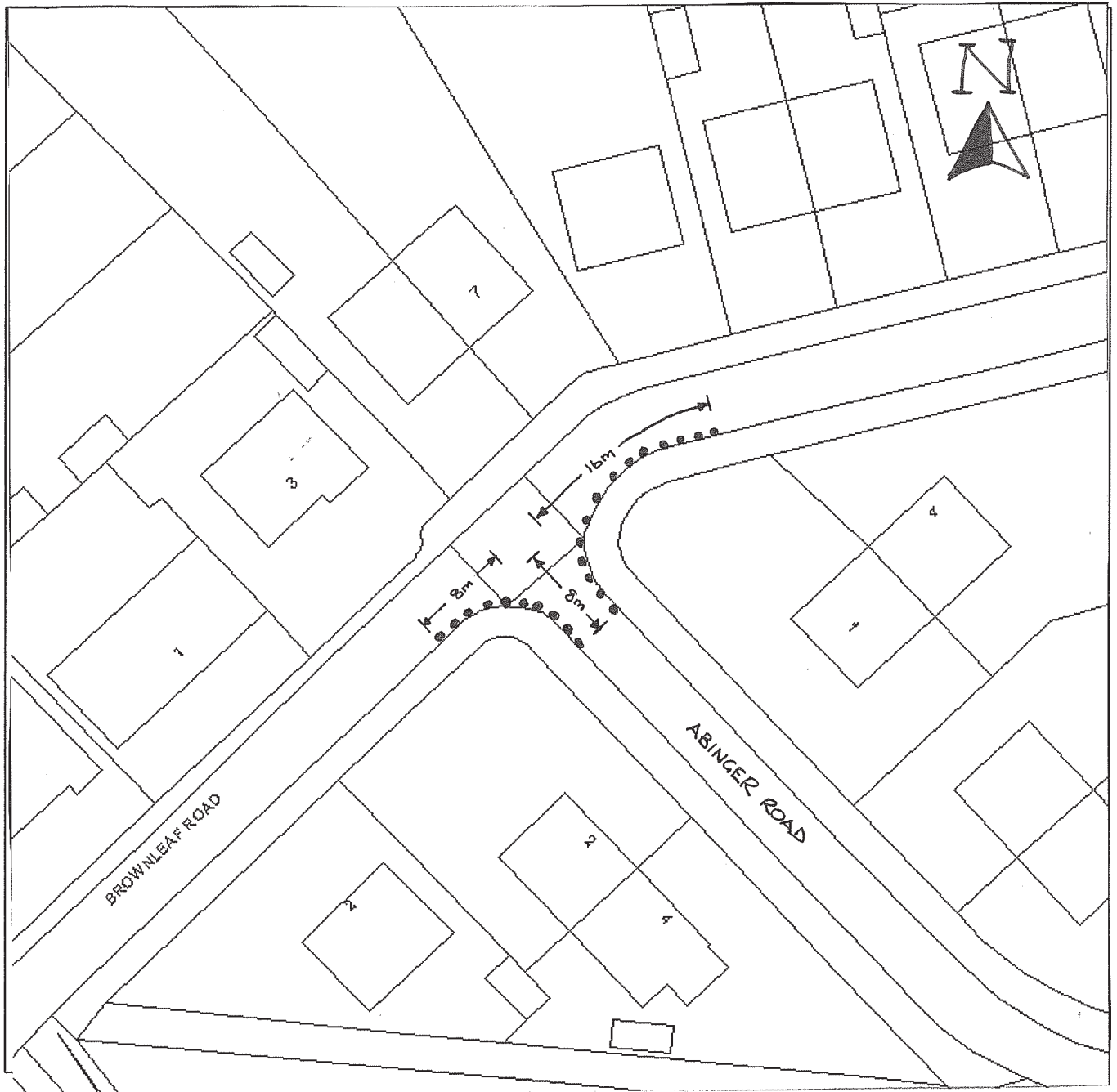

PLAN SHOWING PROPOSED CHANGES TO PARKING RESTRICTION

BROWNLEAF ROAD/ABINGER ROAD, BRIGHTON

KEY:- PROPOSED DOUBLE YELLOW LINES

REASON:- TO IMPROVE SAFETY FOR BOTH PEDESTRAINS AND VEHICLES IT HELPS TO PREVENT OBSTRUCTION TO ALL VEHICLES BUT INPARTICULAR LARGER VEHICLES SUCH AS THE CITY CLEAN VEHICLES

SCALE : NOT TO SCALE REFER ONLY TO MEASUREMENTS

Please see formal notice, to see what other roads have restrictions proposed, where to view the plans and traffic order and how to object or support this proposal